

# TM 9-1240-372-34P

DEPARTMENT OF THE ARMY TECHNICAL MANUAL

---

**DIRECT SUPPORT AND GENERAL SUPPORT  
MAINTENANCE REPAIR PARTS AND SPECIAL TOOLS LIST  
(INCLUDING DEPOT MAINTENANCE REPAIR  
PARTS AND SPECIAL TOOLS)**

**FOR**

**BINOCULARS M3 (1240-670-2491), M7  
(1240-620-2500), M13 (1240-207-2508),  
M13A1 (1240-530-0973), M15A1  
(1240-530-0959), M16 (1240-670-2514)  
AND M17A1 (1240-530-0974)**

---

**HEADQUARTERS, DEPARTMENT OF THE ARMY**

**JULY 1972**

	Page	Illus Figure
2204.4 Shelf Assembly (5580620) .....	38	16
2209.2 Shelf Assembly (5580620) .....	38	16
2204.5 Shelf Assembly (5580620) .....	38	16
2209.3 Shelf Assembly (7670787) .....	38	16
2209.4 Eyepiece Assembly (7673628) .....	41	17
2204.6 Eyepiece Assembly (7673628) .....	40	17
2209.5 Eyepiece Assembly (7673634) .....	40	17
2204.7 Adapter Assembly (7634627) .....	42	18
2209.6 Adapter Assembly (7634627) .....	42	18
2209.7 Adapter Assembly (7634626) .....	42	18
Group 2208. Binoculars M15A1 (6702512) .....	44	19
2211. Binoculars M17A1 (6702518) .....	44	19
2208.1 Body Assembly (5632009) .....	46	20
w/related parts		
2211.3 Body Assembly (5632009) .....	46	20
w/related parts		
2208.2 Cover and Eyepiece Assembly (7672854) .....	48	21
2211.4 Cover and Eyepiece Assembly (7676155) .....	48	21
2208.3 Cover and Eyepiece Assembly (7673633) .....	48	21
2211.5 Cover and Eyepiece Assembly (7673635) .....	48	21
2208.4 Shelf Assembly (5631930) .....	50	22
2211.6 Shelf Assembly (5631930) .....	50	22
2208.5 Shelf Assembly (5631928) .....	50	22
2211.7 Shelf Assembly (7670776) .....	50	22
2208.6 Objective Assembly (5631187) .....	52	23
2211.8 Objective Assembly (5631187) .....	52	23
Section III. Special tools list .....	54	
Section IV. Federal stock number and reference number index .....	56	



# LIST OF ILLUSTRATIONS

Figure	Illustration	Page
1	Binoculars M3, M13 and M13A1 .....	9
2	Binoculars M3 .....	11
3	Axle w/related parts .....	13
4	Objective assembly .....	15
5	Eyepiece assemblies .....	17
6	Shelf assemblies .....	19
7	Binoculars M13 and M13A1 .....	21
8	Cover assemblies .....	23
9	Reticle assembly .....	25
10	Case carrying M62A1 .....	26
11	Filter .....	26
12	Binoculars M7, M16 .....	29
13	Reticle assemblies .....	31
14	Objective assembly .....	33
15	Axle w/related parts .....	34
16	Shelf assemblies .....	39
17	Eyepiece assemblies .....	41
18	Adapter assemblies .....	43
19	Binoculars M15A1 and M17A1 .....	45
20	Body assembly w/related parts .....	47
21	Cover and eyepiece assemblies .....	49
22	Shelf assemblies .....	51
23	Objective assembly .....	53
24	Case carrying M63A1 .....	55



## Section I. INTRODUCTION

### 1. Scope

This manual lists repair parts, special tools, and support equipment required for the performance of direct support general support and depot maintenance of the binoculars, M3, M7, M13, M13A1, M15A1, M16, and M17A1.

### 2. General

This Repair Parts and Special Tools List is divided into the following sections:

*a. Repair Parts List—Section II.* A list of repair parts authorized at the direct support, general support, and depot levels for the performance of maintenance. This list also includes parts which must be removed for the replacement of the authorized parts. Parts lists are composed of functional groups in ascending numerical sequence, with parts in each group listed in figure and item number sequence.

*b. Special Tools List—Section III.* A list of special tools, test and support equipment authorized for the performance of maintenance at the direct support, general support and depot levels.

*c. Federal Stock Number and Reference Number Index—Section IV.* A list, in ascending numerical sequence, of all Federal stock numbers appearing in the listings followed by a list, in alphabetic sequence, of all reference numbers appearing in the listings. Federal stock number and reference numbers are cross-referenced to each illustration figure and item number sequence.

### 3. Explanation of Columns

The following provides an explanation of columns found in the tabular listings.

*a. Source, Maintenance, and Recoverability Codes (SMR).*

(1) *Source Code.* Indicates the manner of acquiring support items for maintenance, repair, or overhaul of end items. Source codes are:

Code	Explanation
PA	Item procured and stocked for anticipated or known usage.

Code	Explanation
PB	Item procured and stocked for insurance purposes because essentiality dictates that a minimum quantity be available in the supply systems.
PC	Item procured and stocked and which otherwise would be coded "PA" except that it is deteriorative in nature.
PD	Support item, excluding support equipment, procured for initial issue or outfitting and stocked only for subsequent or additional initial issues or outfitting. Not subject to automatic replenishment.
PE	Support equipment procured and stocked for initial issue or outfitting to specified maintenance repair activities.
PF	Support equipment which will not be stocked but which will be centrally procured on demand.
MO	Item to be manufactured or fabricated at Organizational level.
MF	Item to be manufactured or fabricated at Direct Support level.
MH	Item to be manufactured or fabricated at General Support.
MD	Item to be manufactured or fabricated at Depot Maintenance level.
AO	Item to be assembled at Organizational level.
AF	Item to be assembled at Direct Support.
AH	Item to be assembled at General Support.
AD	Item to be assembled at Depot Maintenance level.
XA	Item is not procured or stocked because the requirements for the item will result in the replacement of the next higher assembly.
XB	Item is not intended for procurement and is not stocked. If not available thru salvage, requisition.
XC	Installation drawing, diagram, instruction sheet, field service drawing, that is identified by manufacturers part number.

(2) *Maintenance Codes.* Indicates the levels of maintenance authorized to USE and REPAIR support items.

(a) *Use code.* Indicates the lowest maintenance level authorized to remove, replace, and use the support item. Use codes are:

Code	Explanation
C	Used to denote crew or operator maintenance performed within Organizational maintenance.



Code	Explanation
O	Support item is removed, replaced, used at the Organizational level of maintenance.
F	Support item is removed, replaced, used at Direct Support.
H	Support item is removed, replaced, used at General Support.
D	Support item is removed, replaced used at Depot only.

(b) *Repair code*. Indicates whether the item is to be repaired and identifies the lowest maintenance level with the capability to perform complete repair (i.e., all authorized maintenance functions). Repair codes are:

Code	Explanation
O	The lowest maintenance level capable of complete repair of the support item is the Organizational level.
F	The lowest maintenance level capable of complete repair of the support item is Direct Support.
H	The lowest maintenance level capable of complete repair of the support item is General Support.
D	The lowest maintenance level capable of complete repair of the support item is the Depot level.
Z	Non-repairable.

(3) *Recoverability Codes*. Indicates the disposition action on unserviceable items. Recoverability codes are:

Code	Explanation
Z	Non-reparable item. When unserviceable, condemn and dispose at the level authorized to replace the item.
F	Repairable item. When uneconomically repairable, condemn and dispose at Direct Support level.
H	Repairable item. When uneconomically repairable, condemn and dispose at General Support level.
D	Repairable item. When beyond lower level repair capability, return to Depot. Condemnation and disposal not authorized below Depot level.
L	Repairable item. Repair, condemnation and disposal not authorized below depot/specialized repair activity level.
A	Item requires special handling or condemnation procedure because of specific reasons (i.e., precious metal content, high dollar value, critical material or hazardous material). Refer to appropriate manuals/directives for specific instructions.

*b. Federal Stock Number*. Indicates the Federal stock number assigned to the item and will be used for requisitioning purposes.

*c. Description*. Indicates the Federal item name and a minimum description required to identify the item. The last line indicates the reference

number followed by the applicable Federal Supply Code for Manufacturer (FSCM) in parentheses. The FSCM is used as an element in item identification to designate manufacturer or distributor or Government Agency, etc., and is identified in SB 708-42.

*d. Unit of Measure (U/M)*. Indicates the standard or basic quantity by which the listed item is used in performing the actual maintenance function. This measure is expressed by a two-character alphabetical abbreviation, e.g., ea, in, pr, etc., and is the basis used to indicate quantities and allowances in subsequent columns. When the unit of measure differs from the unit of issue, the lowest unit of issue that will satisfy the required units of measure will be requisitioned.

*e. Quantity Incorporated in Unit*. Indicates the quantity of the item used in the breakout shown in the illustration figure, which is prepared for a functional group, subfunctional group, or an assembly. A "V" appearing in this column in lieu of a quantity indicates that no specific quantity is applicable, e.g., shims, spacers, etc.

*f. 30-Day DS/GS Maintenance Allowances*.

(1) The repair parts indicated by asterisk (\*) entries in separate allowance column(s) for DS and GS represents those parts authorized for use at that category of maintenance and will be requisitioned on an "as required" basis.

(2) Allowance quantities are indicated in the special tools list section for special tools, TMDE, and other support equipment.

*g. 1-Year Allowances Per 100 Equipments/Contingency Planning Purposes*. No entries will appear in this column.

*h. Depot Maintenance Allowances Per 100 Equipments*. This column indicates that the items identified with an asterisk (\*) are authorized to be requisitioned "as required."

*i. Illustration*. This column is divided as follows:

(1) *Figure Number*. Indicates the figure number of the illustration on which the item is shown.

(2) *Item Number*. Indicates the callout number used to reference the item on the illustration.

#### 4. Special Information

*a. Usable on codes* are included in Column 3. Uncoded items are applicable to all models. Identification of the usable on codes used in this publication are:



Code	Explanation
A	M3
B	M13
C	M13A1
D	M13, M13A1
E	M3, M13, M13A1
F	M7
G	M7, M16
H	M7, M15A1, M16, M17A1
J	M15A1
K	M15A1, M17A1
L	M16
M	M17A1
N	M16, M17A1
Blank	M3, M13, M13A1, M15A1, M16, M7, M17A1

b. Action change codes indicated in the left-hand margin of the listing page denote the following:

- N—Indicates an added item.
- C—Indicates a change in data.
- R—Indicates a change in FSN only.

c. To maintain disassembly sequence in this manual, a number in parentheses will be displayed immediately to the right of the callout number on the illustration.

## 5. How to Locate Repair Parts

a. When Federal stock number or reference number is unknown:

(1) *First.* Using the table of contents determine the functional or subfunctional group within which the repair part belongs, i.e., engine, engine assembly, transmission, transmission assembly. This is necessary since illustrations are prepared for functional and subfunctional groups, and listings are divided into the same groups.

(2) *Second.* Find the illustration covering the functional or subfunctional group to which the repair part belongs.

(3) *Third.* Identify the repair part on the illustration and note the illustration figure and item number on the repair part.

(4) *Fourth.* Using the Repair Parts Listing, find the functional or subfunctional group to which the repair part belongs and locate the illustration figure and item number noted on the illustration.

b. When Federal stock number or reference number is known:

(1) *First.* Using the index of Federal Stock Numbers and Reference Numbers find the pertinent Federal stock number or reference number. This index is in ascending FSN sequence followed by a list of reference numbers in ascending alpha-

meric sequence, cross-referenced to the illustration figure number and item number.

(2) *Second.* Using the Repair Parts Listing, find the functional or subfunctional group of the repair part and the illustration figure number and item number referenced in the Index of Federal Stock Numbers and Reference Numbers.

## 6. Abbreviations

Abbreviations	Explanation
al	aluminum
aly	alloy
apert	aperture
bfl	back focal length
blk	black
cd	cadmium
cncv	concave
cop	copper
cp	cone point
crs	corrosion resistant steel
cs	case
ctsk	countersunk head
dbl	double
dev	development
dia	diameter
dr	drive
ecc	eccentric
efl	effective focal length
enam	enamel
ext	external
filh	flat fillister head
filh	fillister head
flt	flashlight
fnsh	finish
fp	flat point
gl	glass
gnd	ground
hex soc	hexagon socket
hd	head
hgt	height
idx	index
intl	internal
l	long
lg	length
lt	light
mach	machine
nf	national fine
ni sil	nickel silver
nkl	nickel
no	number
ns	national special (thread)
oa	overall
od	outside diameter
oxd	oxide
pl	plate
pld	plated
pnh	pan head
por	porro
psm	prism
psvt	passivate
rbr	rubber



**Abbreviations**

rec  
sc  
stl  
thd  
thk  
tng  
unf  
uns  
yd  
w

**Explanation**

recess  
scale  
steel  
thread  
thick  
training  
unified fine thread  
unified special thread  
yard  
wide

**7. Recommendations for Maintenance Publications Improvements**

You can improve this manual by calling attention to errors and by recommending improvements, using DA Form 2028 (Recommended Changes to Publications) or by a letter, and mailing directly to Commanding Officer, Frankford Arsenal, ATTN: AMSWE-MAF-W3100, Philadelphia, Pennsylvania, 19137. A reply will be furnished directly to you.













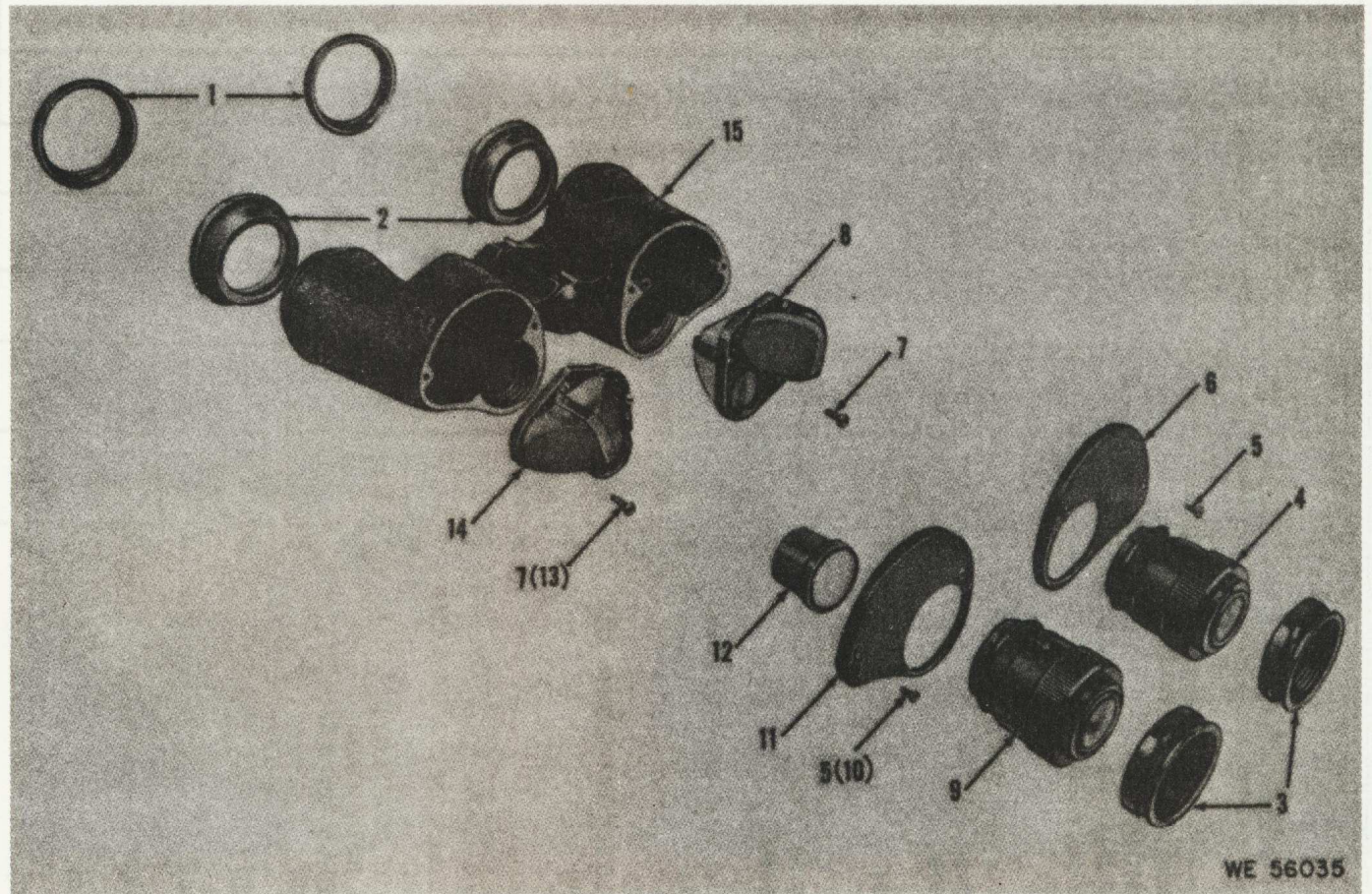

WE 56035

Figure 2. Binoculars M3







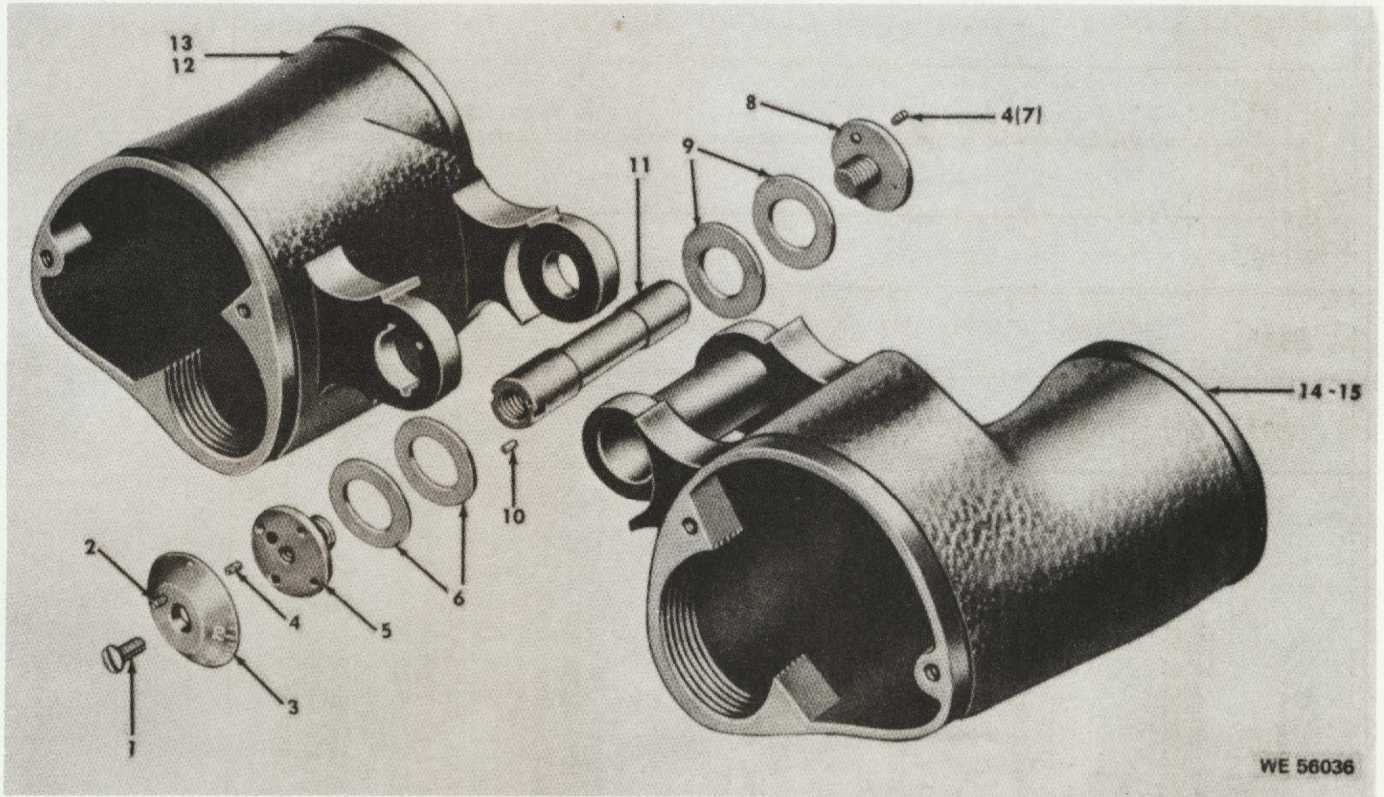
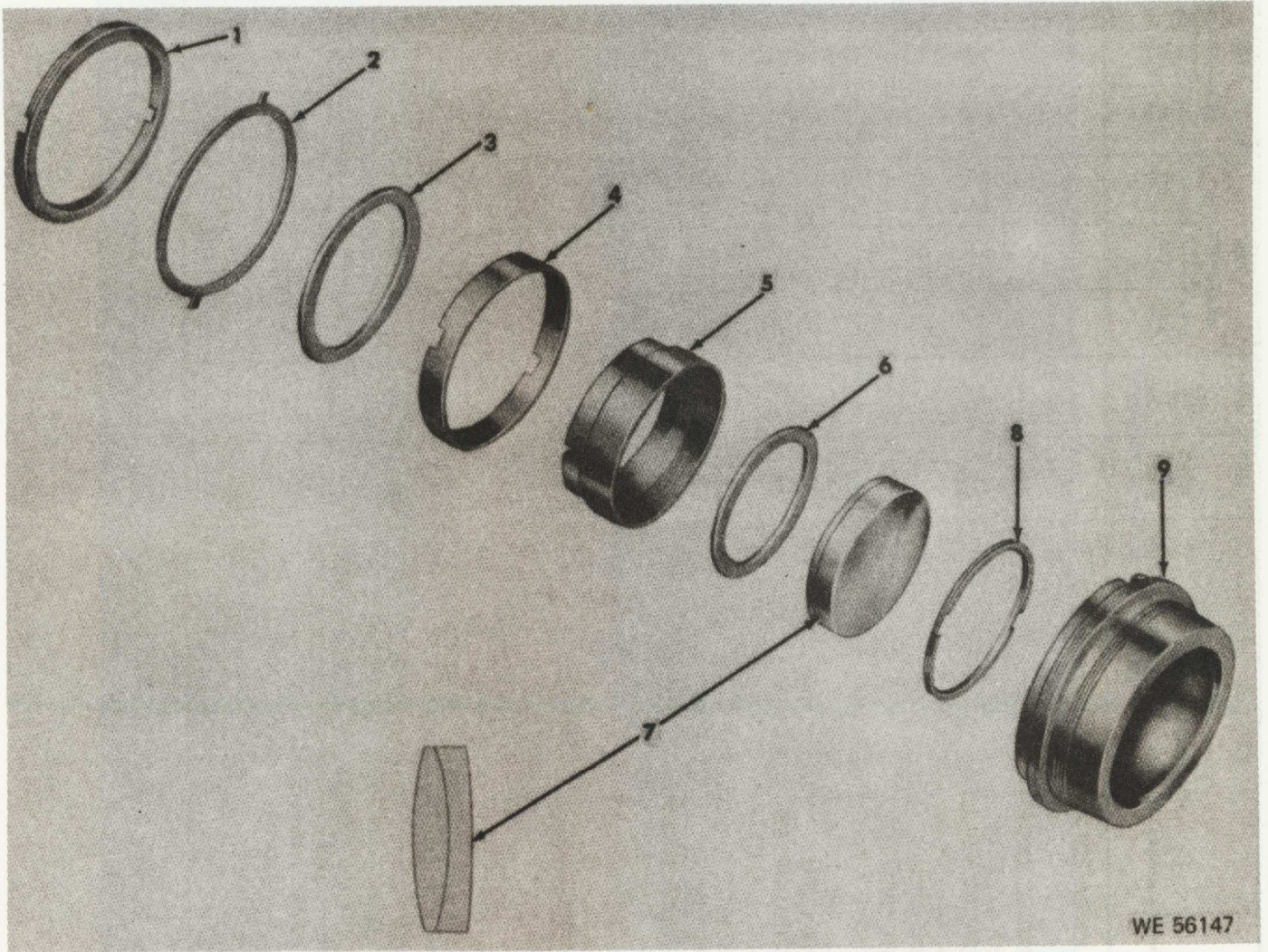

Figure 3. Axle w/related parts



Act on code	(1) SMR CODE			(2) Federal stock No.	(3) Description Reference Number & Mfr Code	(4) Unit of meas	(5) Qty inc in unit	(6) 30-day DS maint allowance			(7) 30-day GS maint allowance			(8) 1-Yr alw per 100 equip entgcy	(9) Depot maint alw per 100 equip	(10) Illustration	
	(a) Source	(b) Maint	(c) Recov					(a) 1-20	(b) 21-50	(c) 51-100	(a) 1-20	(b) 21-50	(c) 51-100			(a) Fig No.	(b) Item No.
N	PA-HZ-Z			5365-758-6840	OBJECTIVE ASSEMBLY (7674286) RING 7586840 (19200)	EA	2				*	*		*	4	1	
N	PA-HZ-Z			5310-530-9441	WASHER, KEY AL, 2 EXT KEYS 1.250 ID, 1.750 OD OA, .016 THK 7586841 (19200)	EA	2				*	*		*	4	2	
N	PA-HZ-Z			1240-518-5466	GASKET 7586842 (19200) CELL, OPTICAL ELEMENT AL BLK OXD FNH, SLTD FACE DR 0.200 H, 1.480 DIA, 0.020 ECC 5185466 (19200)	EA	2				*	*		*	4	3	
N	PA-HZ-Z			1240-764-1795	CELL, OPTICAL ELEMENT AL ANDZ, 1.430 DIA, 0.497 OA H, 1.340-48NS-3B 0.200 L, 0.020 ECC, SLTD FACE DR 7641795 (19200)	EA	2				*	*		*	4	5	
C	PA-HZ-Z			1240-518-5193	GASKET 7586843 (19200) LENS, OPTICAL INSTRUMENT GL, DBL CNCV, 1.259 DIA, 0.338 AXIAL THK 5.191 EFL, 5.012 BFL 5185193 (19200)	EA	2				*	*		*	4	6	
C	PA-HZ-Z				RING, EXTERNALLY THREADED AL ANDZ 1.340-48 NS-3A THD, 1.181 ID, .078 OA L 5185465 (19200)	EA	2				*	*		*	4	8	
N	PA-HZ-Z			1240-531-9083	CELL, OPTICAL ELEMENT AL, ANDZ, 0.185 DIA OA, 0.700 H OA 1 5/8-20 UNS-2B, 1.850-20 UNS-2A 5319083 (19200)	EA	2				*	*		*	4	9	





WE 56147

Figure 4. Objective assembly



Act on code	(1) SMR CODE			(2) Federal stock No.	(3) Description Reference Number & Mfr Code      Useable on Code	(4) Unit of meas	(5) Qty inc in unit	(6) 30-day DS maint allowance			(7) 30-day GS maint allowance			(8) 1-Yr alw per 100 equip cntgcy	(9) Depot maint alw per 100 equip	(10) Illustration	
	(a) Source	(b) Maint	(c) Recov					(a) 1-20	(b) 21-50	(c) 51-100	(a) 1-20	(b) 21-50	(c) 51-100			(a) Fig No.	(b) Item No.
N	XB-HZ-Z				EYEPIECE ASSEMBLY (7673624) (7673625) ADAPTER, EYEPIECE 6174603 (19200)	EA	2								5	1	
C	PA-HZ-Z		5305-638-1786	A	SCREW, HEADLESS GRES, NO 1 72-NF-3A, 3/16 L 5185461 (19200)	EA	2	*	*	*	*	*	*	*	5	2	
N	PA-HZ-Z		5365-291-3578	A	RING CLAMPING THD SIZE 1.033-36 UNS-3, ID .751, OA .145L 5185460 (00000)	EA	2	*	*	*	*	*	*	*	5	3	
N	XB-HZ-Z			A	SCALE, DIOPTR 6269643 (19200)	EA	2								5	4	
N	PA-HZ-Z			A	RING, STOP 5185462 (19200)	EA	2	*	*	*	*	*	*	*	5	5	
N	XB-HZ-Z			A	CELL, ASSEMBLY 7641787 (19200)	EA	2								5	6	
N	PA-HZ-Z			A	RING, RETAINING 5185458 (19200)	EA	1	*	*	*	*	*	*	*	5	7	
N	PA-HZ-Z			A	RING, RETAINING 5185463 (19200)	EA	1	*	*	*	*	*	*	*	5	8	
N	PA-HZ-Z		1240-518-5192	A	LENS, OPTICAL INSTRUMENT GLASS 0.072 EDGE THK, 0.205 AXIAL THK, 0.906 DIA. 1.623 EQUIV. FOCAL LG. 5185192 (19200)	EA	2	*	*	*	*	*	*	*	5	9	
N	PA-HZ-Z		1240-518-5191	A	LENS, OPTICAL, INSTRUMENT GLASS DBLE CONVEX, AND PLANO CONVEX 0.291 EDGE THK, 0.409 AXIAL THK, 0.689 DIA, 1.160 EQUIV. FOCAL LG. 0.905 BACK FOCAL LG. 5185191 (19200)	EA	2	*	*	*	*	*	*	*	5	10	
N	XB-HZ-Z			A	SEPARATOR 5185459 (19200)	EA	2								5	11	



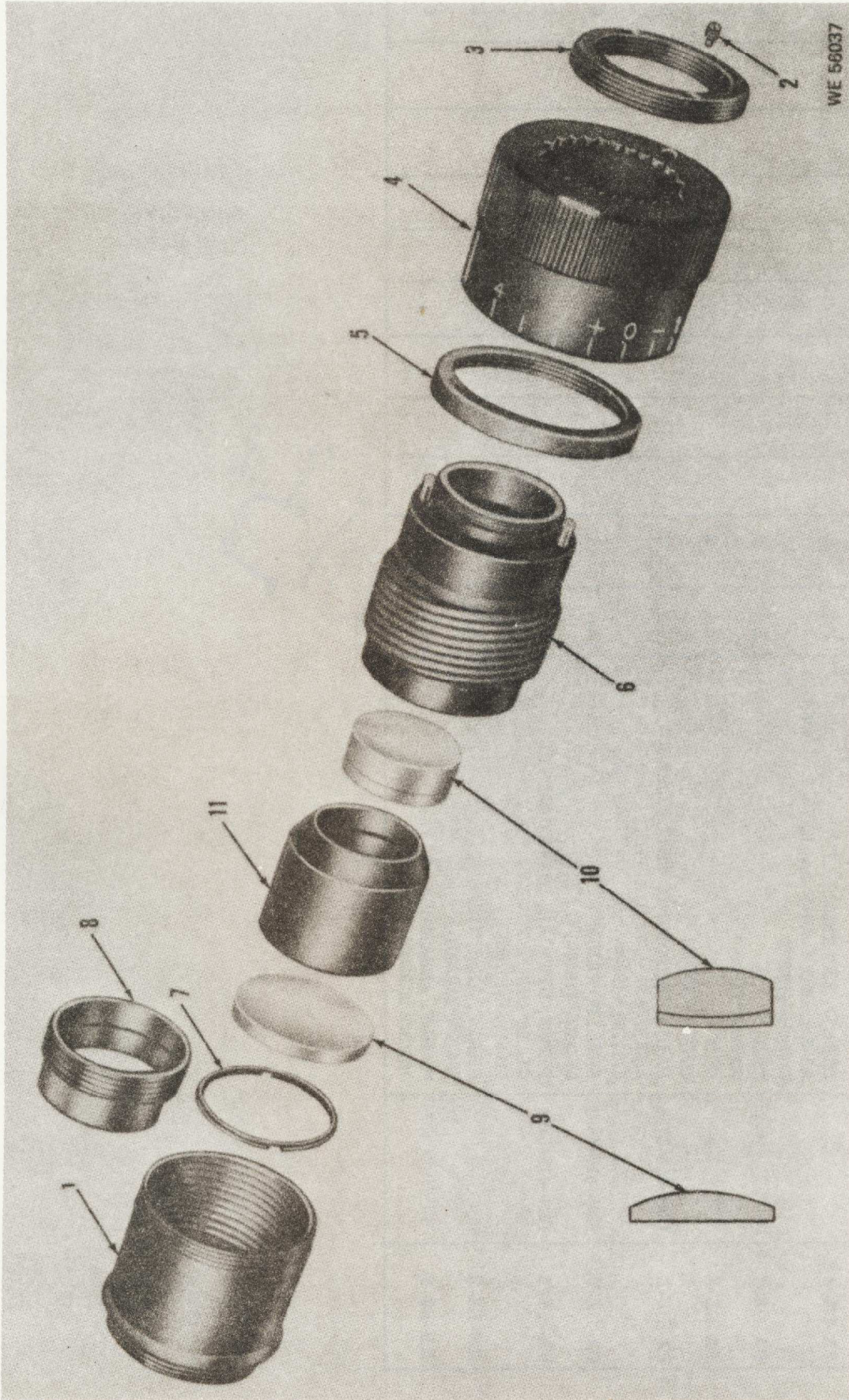
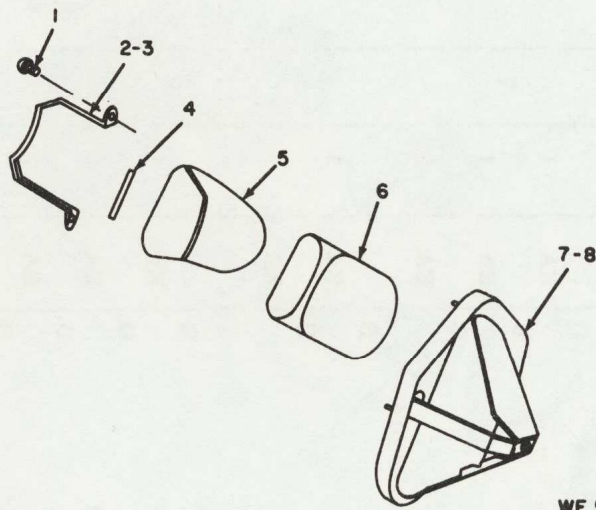

Figure 5. Eyepiece assemblies









WE 56038

Figure 6. Shelf assemblies







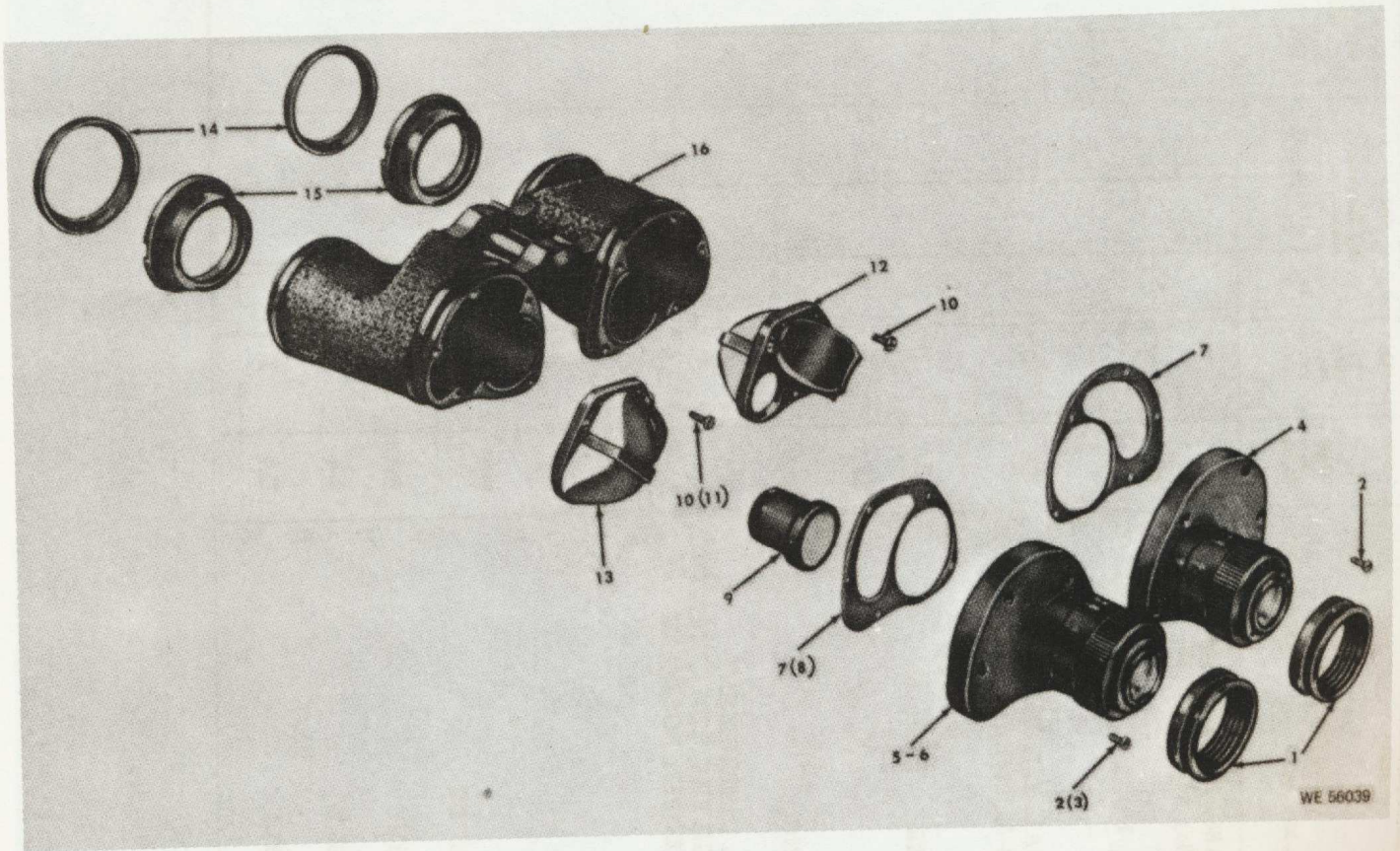

WE 56039

Figure 7. Binoculars M13 and M13A1







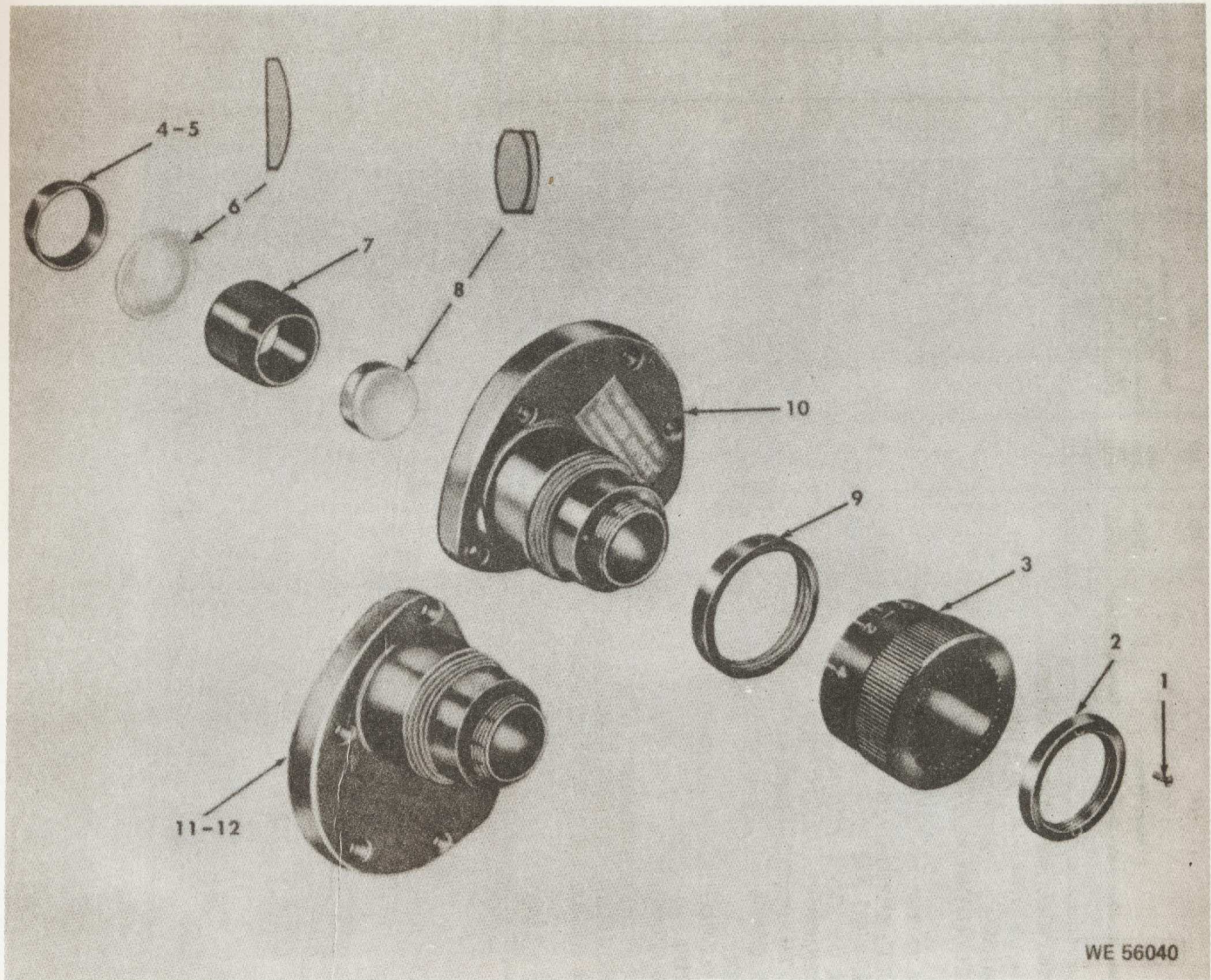

Figure 8. Cover assemblies



Act on code	(1) SMR CODE			(2) Federal stock No.	(3) Description Reference Number & Mfr Code      Usable on Code	(4) Unit of meas	(5) Qty inc in unit	(6) 30-day DS maint allowance			(7) 30-day GS maint allowance			(8) 1-Yr alw per 100 equip cntgcy	(9) Depot maint alw per 100 equip	(10) Illustration	
	(a) Source	(b) Maint	(c) Recov					(a) 1-20	(b) 21-50	(c) 51-100	(a) 1-20	(b) 21-50	(c) 51-100			(a) Fig No.	(b) Item No.
C	PA-HZ-Z			1240-574-6417	RETICLE ASSEMBLY (7199590) RETAINER, OPTICAL ELEMENT AL ANODIZED, 0.897-32NS-3A, 0.172 OA L 0.785 HOLE DIA., 2 SLOTS 0.031W, 0.031 DEEP 5185475 (19200)      E	EA	1				*	*		*	9	1	
N	PA-HZ-Z			1240-617-3980	RETICLE, OPTICAL INSTRUMENT GLASS, 0 TO 2000 YD. RANGE SC., 1.523 INDEX OF REFRACTION, 46.0 DISPERSION 0.039 EDGE THK. 0.080 AXIAL THK. 0.829DIA 0.022 BEVEL DEPTH 6173980 (19200)      E	EA	1				*	*		*	9	2	
N	PA-HZ-Z			1240-520-4750	SPACER AL., 0.745 HD. ID., 0.762 BASE ID, 0.843 OD 0.168 THK 5204750 (19200)      E	EA	1				*	*		*	9	3	
N	PA-HZ-Z			1240-531-9082	CELL OPTICAL ELEMENT AL. ANODIZED, 0.897 DIA, 0.893 OA H, 0.807-48 NX-3A, .140 L, 0.897-72 NS-3A 0.121 L 5319082 (19200)      E	EA	1				*	*		*	9	4	



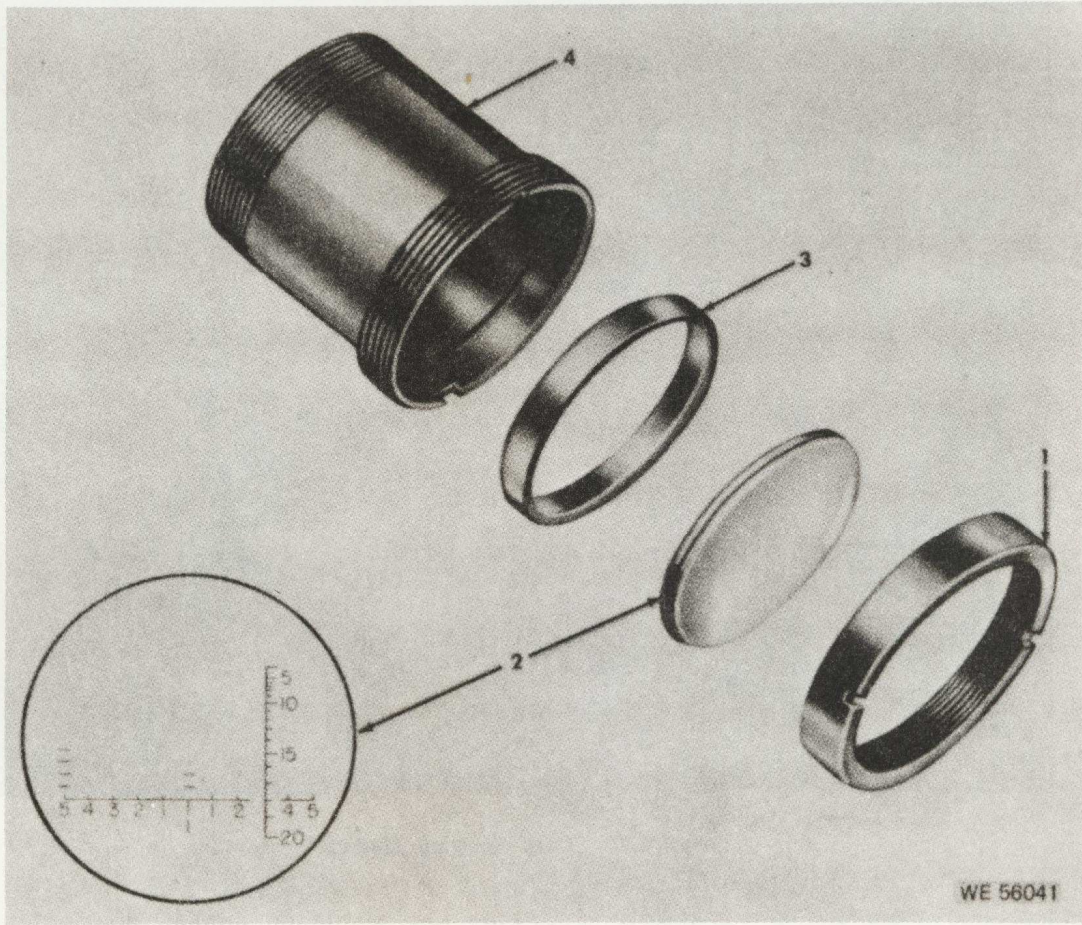

Figure 9. Reticle assembly





Figure 10. Case carrying M62A1

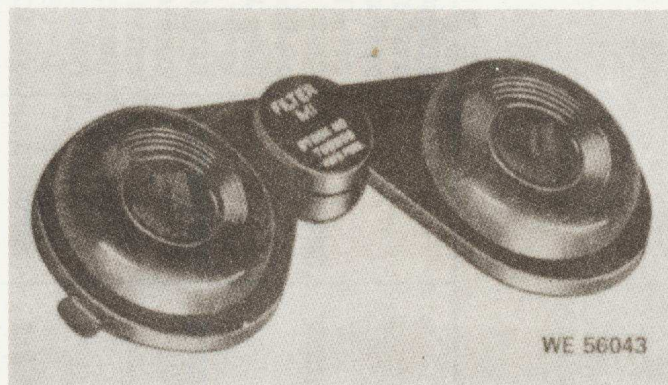

Figure 11. Filter



**Page 27 is a blank page**







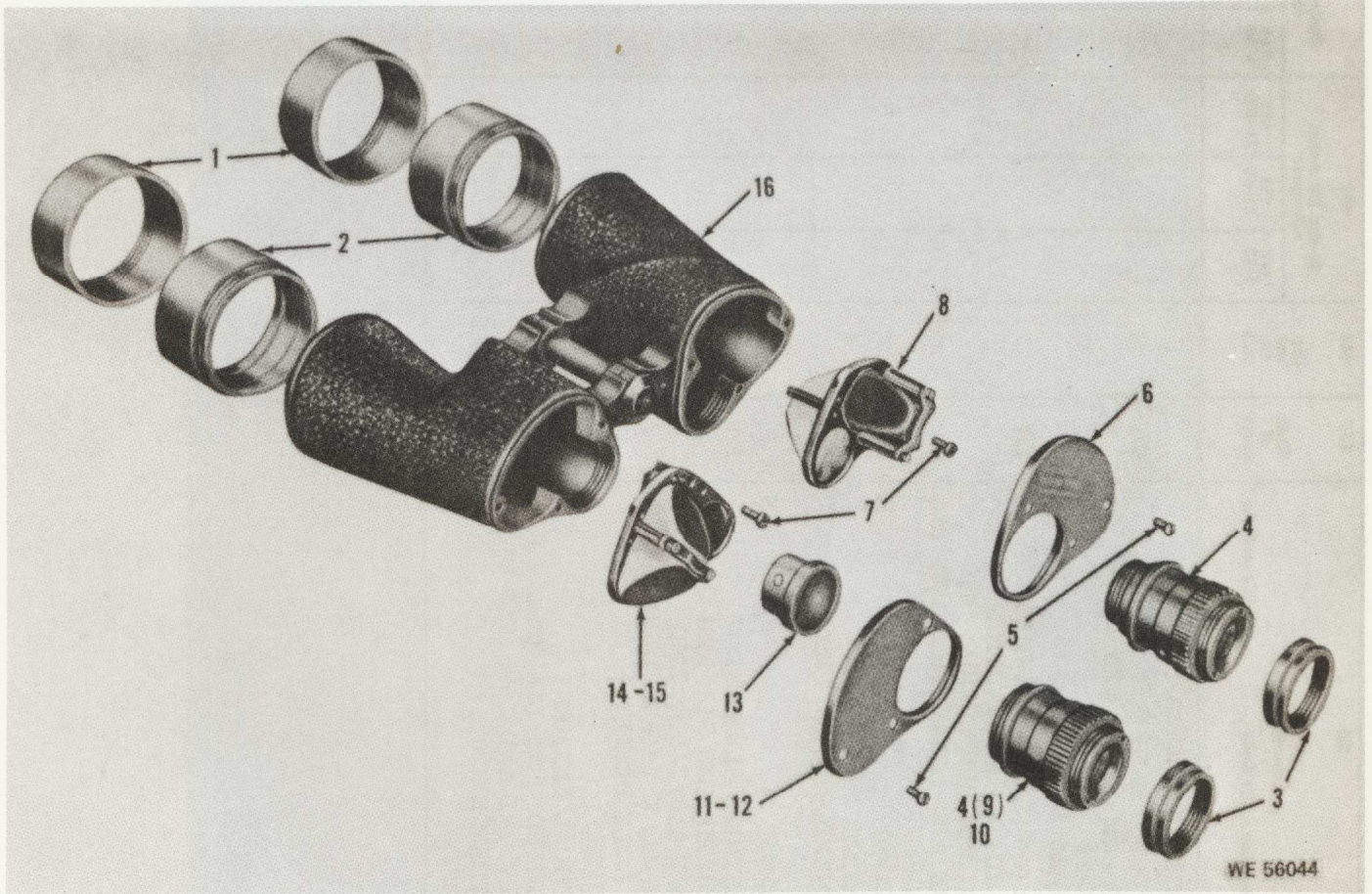
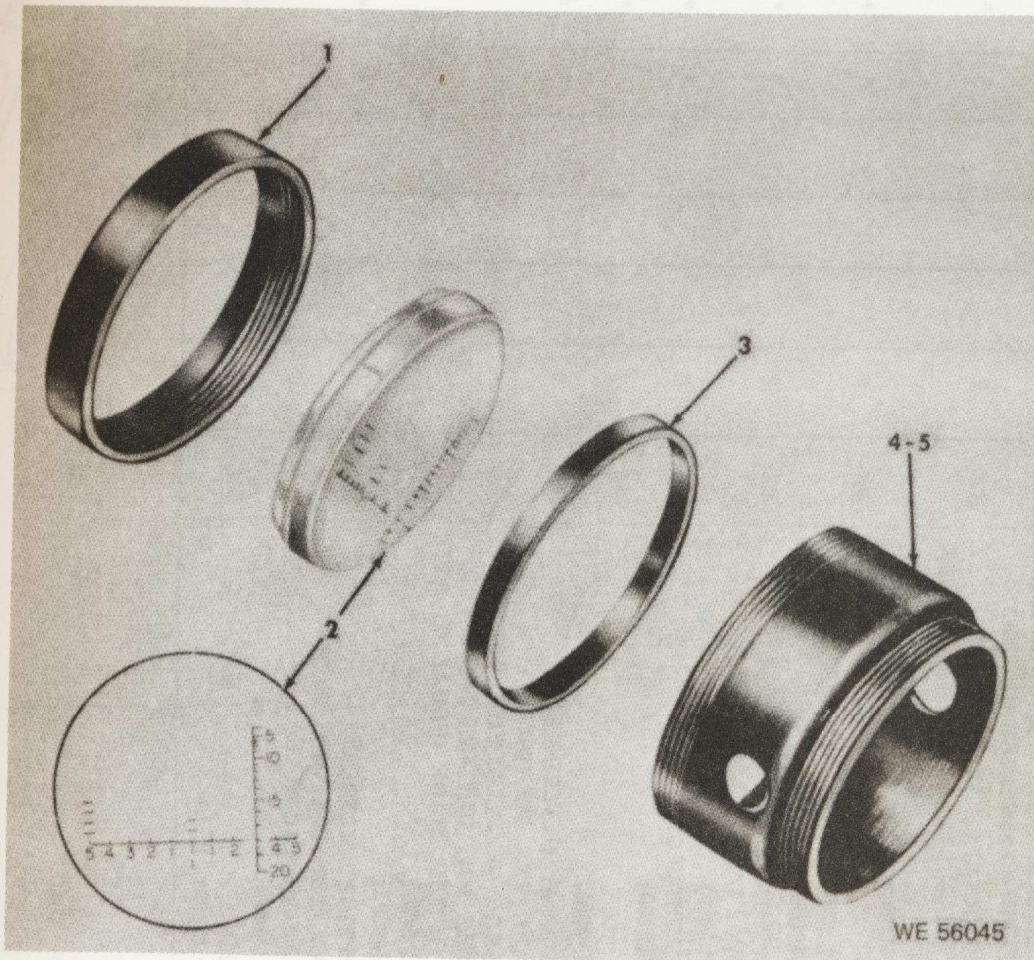

Figure 12. Binoculars M7, M16



Act on code	(1) SMR CODE			(2) Federal stock No.	(3) References Number & Mfr Code Description Usable on Code	(4) Unit of meas	(5) Qty inc in unit	(6) 30-day DS maint allowance			(7) 30-day GS maint allowance			(8) 1-Yr alw per equip cntgcy	(9) Depot maint alw per 100 equip	(10) Illustration	
	(a) Source	(b) Maint	(c) Recov					(a) 1-20	(b) 21-50	(c) 51-100	(a) 1-20	(b) 21-50	(c) 51-100			(a) Fig No.	(b) Item No.
C	PA-HZ-Z			1240-318-4399	RETICLES (7636819), (7636815) CELL, OPTICAL ELEMENT AL, ANDZ, 1.120 OA DIA, 0.220 OA H 1.080-48NS-3B 7578185 (19200)	EA	1				*	*		*	13	1	
N	PA-HZ-Z			1240-763-6816	RETICLE, OPTICAL INSTRUMENT GL, 1.5838 IDX OF REFRACTION 46.0 ANGSTROM DISPERSION, 0.625 EDGE THK 0.120 AXIAL THK, 1.022 DIA BEVELED 7636816 (19200)	EA	1				*	*		*	13	2	
N	PA-HZ-Z			5340-757-8186	SPACER, RING AL, ANODIZED, 0.965 ID, 1.022 OD 0.23 THK 7578186 (00000)	EA	1				*	*		*	13	3	
N	PA-HZ-Z				CELL, RECTICLE ELEMENT AL, ANODIZED, 1.080 DIA, 0.724 OA HGT, 1-48NS-3A X 0.100 L ONE END 1-080-48NS-3A X 0.160 L OTHER END, DRILLED HOLE DRIVE 7278201 (19200)	EA	1				*	*		*	13	4	
N	PA-HZ-Z			1240-757-8184	CELL, OPTICAL ELEMENT AL, ANODIZED, 1.080 DIA, 0.593 OA H, 1-48NS-3A X ONE END, 1.080-48NS-3A X 0.160 L, OTHER END 7578184 (19200)	EA	1				*	*		*	13	5	





WE 56045

Figure 13. Reticle assemblies







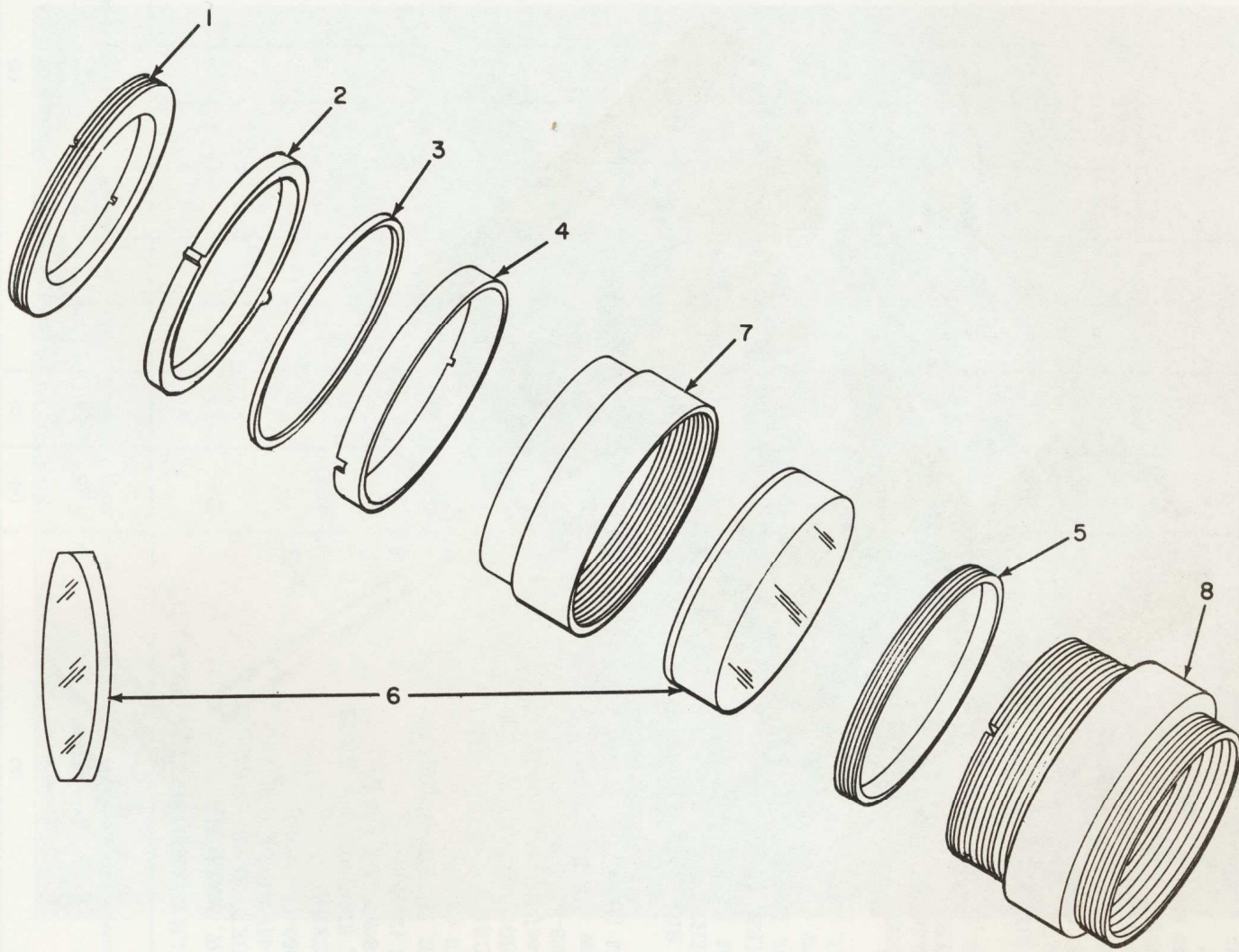

WE 56046

Figure 14. Objective assembly







Act on code	(1) SMR CODE			(2) Federal stock No.	(3) Description Reference Number & Mfr Code	(4) Unit of meas	(5) Qty inc in unit	(6) 30-day DS maint allowance			(7) 30-day GS maint allowance			(8) 1-Yr slw per 100 equip entgcy	(9) Depot maint slw per 100 equip	(10) Illustration	
	(a) Source	(b) Maint	(c) Recov					(a) 1-20	(b) 21-50	(c) 51-100	(a) 1-20	(b) 21-50	(c) 51-100			(a) Fig No.	(b) Item No.
N	PA-HZ-Z			5305-734-1581	AXLE (5182044) W/RELATED PARTS SCREW, MACHINE FL, CSKH, SLTD, CRES, PSVT NO 4-48UNF-2A, 1/4 L MS51960-17 (96906)	EA	1	*	*	*	*	*	*	*	15	1	
C	PA-HZ-Z				H SETSCREW HDLS, SLOT DR, FP, CRES NO 0-80NF-2A, 1/8 L 541053 (21450)	EA	1	*	*	*	*	*	*	*	15	2	
C	PA-HZ-Z			5355-531-8012	H SCALE, INTERPUILLARY 5318012 (00000)	EA	1	*	*	*	*	*	*	*	15	3	
N	PA-HZ-Z			5305-081-2651	H SETSCREW HEX SOC, CP, CRES PSVT NO 2-64UNF-3A, 3/32 L MS51038-15 (96906)	EA	2	*	*	*	*	*	*	*	15	4	
	PA-HZ-Z				H SCREW 5182043 (19200)	EA	1	*	*	*	*	*	*	*	15	5	
N	PA-HZ-Z			5340-518-3734	H SHIM NKL, SIL, 0.421 APERT DIA, 0.750 OD, 0.005 THK, 5183734 (19200)	EA	1	*	*	*	*	*	*	*	15	6	
	PA-HZ-Z				H WASHER, FLAT 7579002 (19200)	EA	1	*	*	*	*	*	*	*	15	7	
N	PA-HZ-Z			1240-695-0154	H SCREW 5182042 (19200)	EA	1	*	*	*	*	*	*	*	15	9	
N	PA-HZ-Z			5340-757-9001	H SHIM COP, NKL, ZINC ALY 0.320-0.336 DIA OF APERT, 0.742-0.758 OD, 0.007 THK 7579001 (19200)	EA	1	*	*	*	*	*	*	*	15	10	
N	PA-HZ-Z			5340-518-3733	H SHIM NKL, SIL, 0.320-0.336 DIA OF APERT, 0.742-0.758 OD, 0.005 THK 5183733 (19200)	EA	1	*	*	*	*	*	*	*	15	11	
N	PA-DZ-Z			5315-518-3732	H PIN, STRAIGHT HEADLESS CRES, GND BODY FNISH, 0.780-0.785 DIA, 0.112 OA L 5183732 (19200)	EA	2	*	*	*	*	*	*	*	15	12	
N	PA-DZ-Z			1240-518-2044	H AXLE 5182044 (19200)	EA	1	*	*	*	*	*	*	*	15	13	







**Page 37 is blank**



Act on code	(1) SMR CODE			(2) Federal stock No.	(3) Description Reference Number & Mfr Code		(4) Unit of meas	(5) Qty inc in unit	(6) 30-day DS maint allowance			(7) 30-day GS maint allowance			(8) 1-Yr alw per 100 equip entrgy	(9) Depot maint alw per 100 equip	(10) Illustration	
	(a) Source	(b) Maint	(c) Recov		(a) 1-20	(b) 21-50			(c) 51-100	(a) 1-20	(b) 21-50	(c) 51-100	(a) Fig No.	(b) Item No.				
N	PA-DZ-Z			5305-527-5546	SHELF ASSEMBLIES (5580620) (5580619) AND (7670787)		EA	8						*	16	1		
					SCREW, MACHINE FFILH, SLTD DR, NKL SIL ALY, NO 0-80NF-2A, 3/16 L 5044194 (00000)		EA	2						*	16	2		
N	PA-DZ-Z			5340-520-4266	CLIP, PRISM (RIGHT)		EA	2						*	16	3		
C	PA-DZ-Z			1240-518-3736	CLIP, PRISM (LEFT)		EA	4						*	16	4		
					PAD, CUSHIONING CELLULAR RBR, 3/32 OA W, 1/32 OA THK, 1/2 OA L 5188736 (19200)		EA	4						*	16	5		
N	PA-DZ-Z			1240-617-7055	SHIELD, PRISM		EA	4						*	16	6		
N	PA-DZ-Z			1240-763-3945	POST, PRISM		EA	4						*	16	7		
N	PA-DZ-Z			5315-520-4269	POST, PRISM		EA	2						*	16	8		
N	PA-DZ-Z			1240-520-4256	PRISM, OPTICAL INSTRUMENT GL, POR PSM, 90 DEGREE LT DEVN 5204269 (19200)		EA	4						*	16	8		
					PRISM, OPTICAL INSTRUMENT GL, POR PSM, 90 DEGREE LT DEVN 5204256 (19200)		EA	2						*	16	15		
N	PA-DZ-Z			5307-520-4268	STUD, EXTENSION AL, 1.140 OA L, NO 5-44NF-3A, 0.3035 L, EXT THD, NO 4-48NF-3A, 1/4 L, INTL THD 5204268 (00000)		EA	1						*	16	17		
N	XB-DZ-Z				SHELF ASSEMBLY, PRISM, STRIPPED (RIGHT)		EA	1						*	16	18		
N	XB-DZ-Z				SHELF ASSEMBLY, PRISM STRIPPED (LEFT)		EA	1						*	16	18		
N	XB-DZ-Z				SHELF ASSEMBLY 6177047 (19200)		EA	1						*	16	19		
					SHELF ASSEMBLY 7636820 (19200)		EA	1						*	16	19		



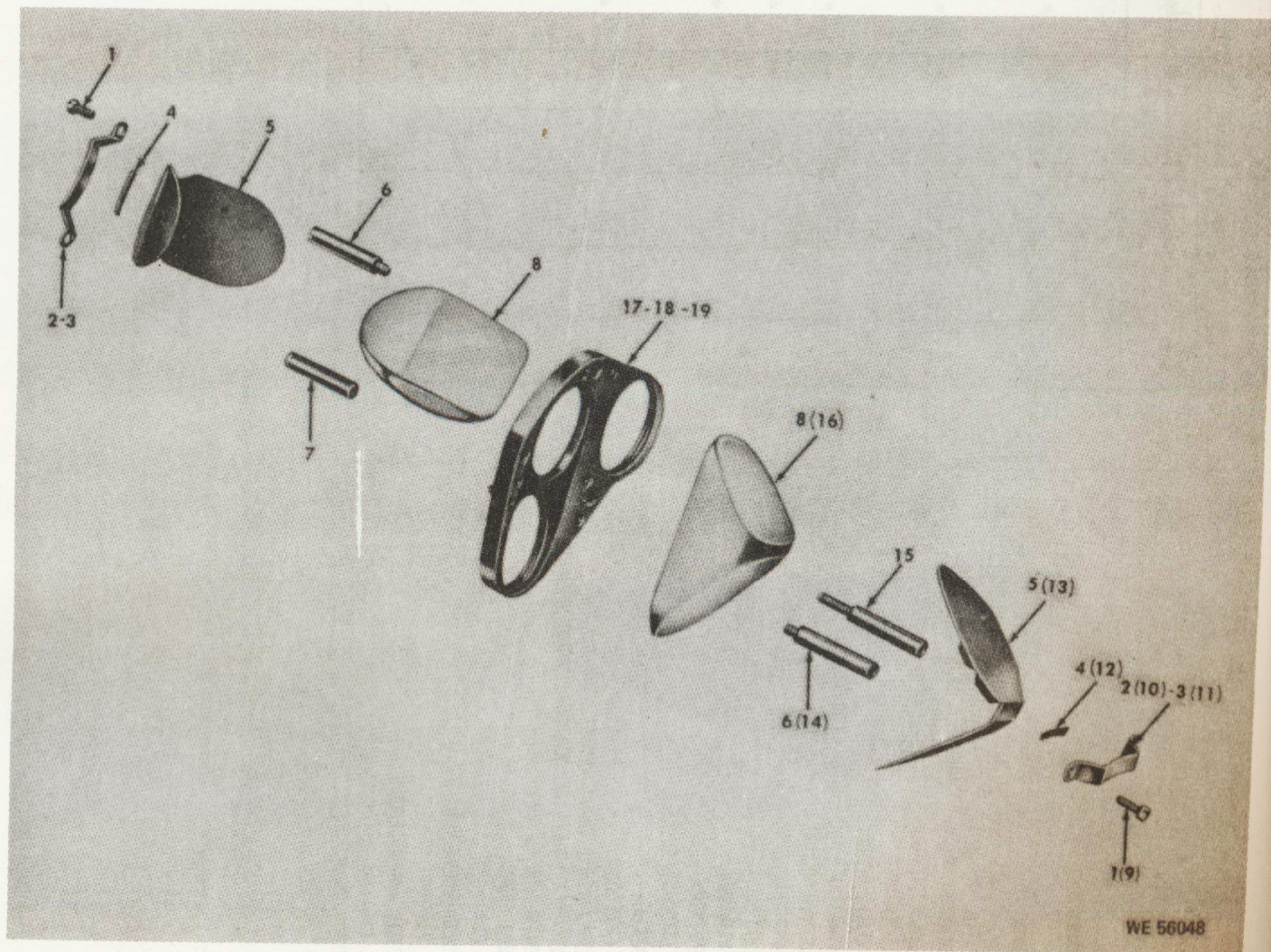

Figure 16. Shelf assemblies.



Act on code	(1) SMR CODE			(2) Federal stock No.	(3) Description Reference Number & Mfr Code      Useable on Code		(4) Unit of meas	(5) Qty inc in unit	(6) 30-day DS maint allowance			(7) 30-day GS maint allowance			(8) 1-Yr slw per 100 equip entgcy	(9) Depot maint slw per 100 equip	(10) Illustration	
	(a) Source	(b) Maint	(c) Recov		(a) 1-20	(b) 21-50			(c) 51-100	(a) 1-20	(b) 21-50	(c) 51-100	(a) Fig No.	(b) Item No.				
C	PA-HZ-Z			5305-282-7659	<b>EYEPIECE ASSEMBLIES (7673628), (7673634)</b>		EA	2	*	*	*	*	*		*	17	1	
N	PA-HZ-Z			5365-291-3579	SETSCREW HDLS, CP, CRES, PSVT FNSH, NO 1-72UNF-2A, 3/32 L 540963 (21450)	G	EA	2	*	*	*	*	*		*	17	2	
N	XB-HZ-Z				RING, CLAMPING 5204261 (00000)	G	EA	2	*	*	*	*	*		*	17	3	
N	PA-HZ-Z			1240-507-8280	SCALE, DIOPTER 6177051 (19200)	G	EA	2	*	*	*	*	*		*	17	4	
N	PA-HZ-Z			5365-200-5399	RING, RETAINING 7575241 (19200)	G	EA	1	*	*	*	*	*		*	17	5	
N	PA-HZ-Z			1240-757-5229	RING, RETAINING 7578187 (19200)	L	EA	2	*	*	*	*	*		*	17	6	
N	XB-HZ-Z				LENS, FIELD 7575229 (19200)	G	EA	2	*	*	*	*	*		*	17	7	
N	PA-HZ-Z				SEPARATOR 7575237 (19200)	G	EA	2	*	*	*	*	*		*	17	8	
C	PA-HZ-Z			1240-757-5230	LENS, OPTICAL INSTRUMENT GL, DBL CVX, PLANO CNCV, 0.690 DIA, 0.175 EDGE THK, 0.275 AXIAL THK, 1.446 EFL, 1.281 BFL 7575230 (19200)	G	EA	2	*	*	*	*	*		*	17	9	
N	PA-HZ-Z			1240-763-4627	ADAPTER ASSEMBLY 7634627 (19200)	G	EA	1	*	*	*	*	*		*	17	10	
N	PA-HZ-Z			1240-763-4626	ADAPTER ASSEMBLY 7634626 (19200)	L	EA	1	*	*	*	*	*		*	17	10	



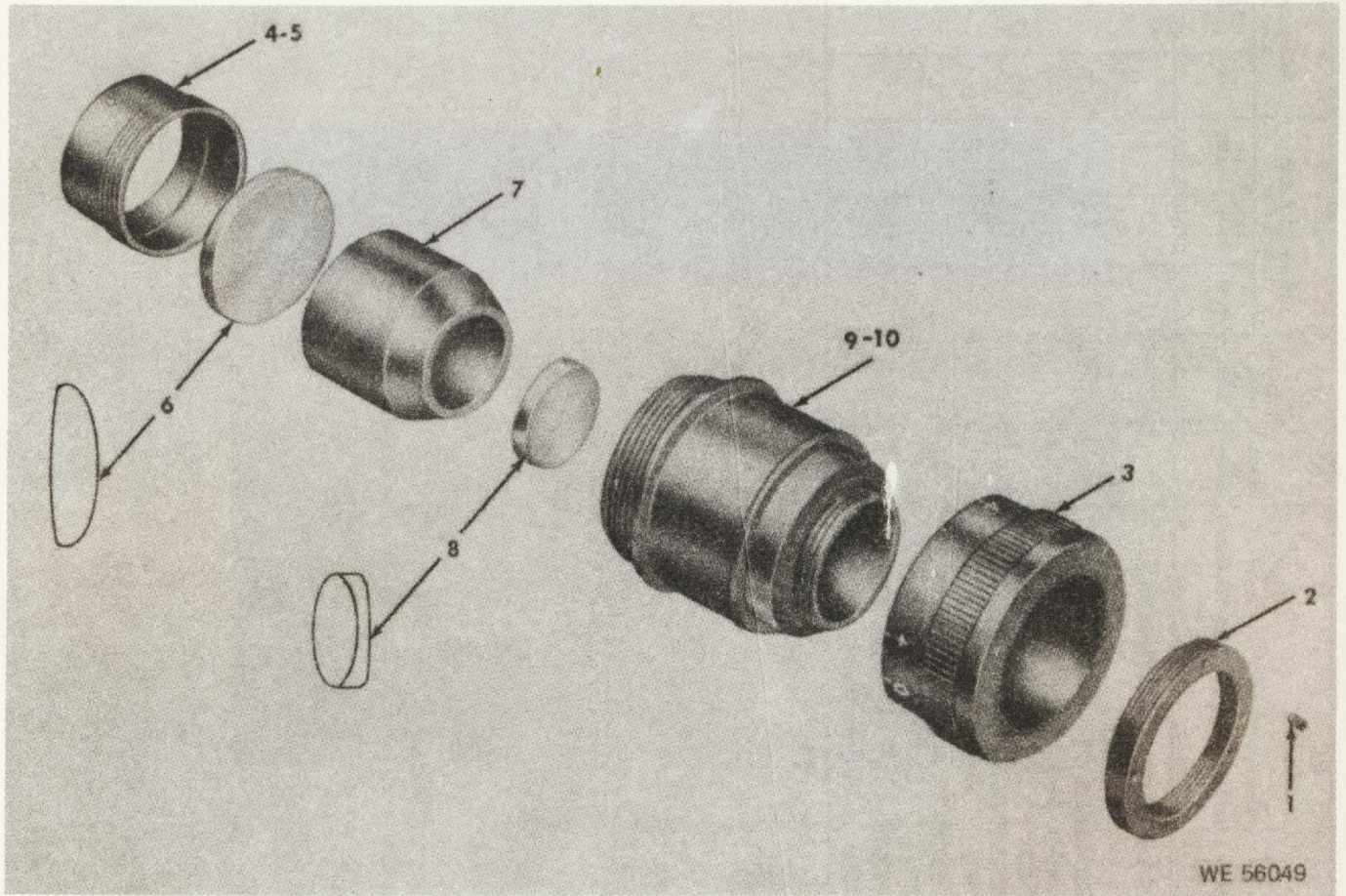

Figure 17. Eyepiece assemblies



Act on code	(1) SMR CODE			(2) Federal stock No.	(3) Description Reference Number & Mfr Code      Usable on Code		(4) Unit of meas	(5) Qty inc in unit	(6) 30-day DS maint allowance			(7) 30-day GS maint allowance			(8) 1-Yr alw per 100 equip cntgcy	(9) Depot maint slw per 100 equip	(10) Illustration	
	(a) Source	(b) Maint	(c) Recov		(a) 1-20	(b) 21-50			(c) 51-100	(a) 1-20	(b) 21-50	(c) 51-100	(a) Fir No.	(b) Item No.				
N	PA-HZ-Z			5365-520-4262	<b>ADAPTER ASSEMBLIES (7634627)</b> (7634626)		EA	2				*			*	18	1	
N	XA-				RING EXTERNALLY THREADED AL, 1.277-32NS-3, 13/64L 5204262 (19200)		G	2				*			*	18	2	
N	XA-				ADAPTER EYEPIECE 6177049 (19200)		L	1				*			*	18	3	
N	XA-				CELL EYEPIECE 7636818 (19200) CELL EYEPIECE 6177050 (19200)		G	2				*			*	18	4	



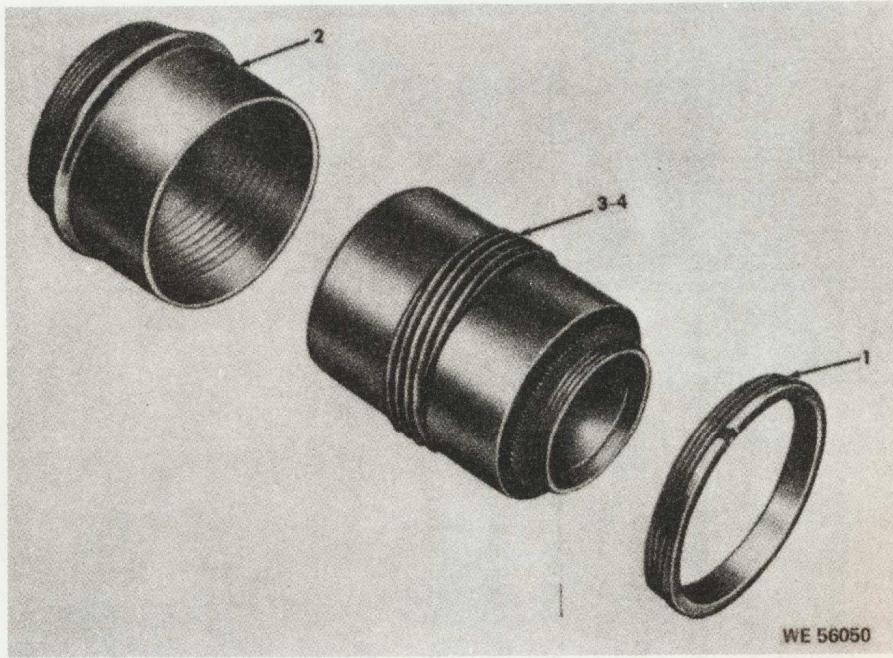

Figure 18. Adapter assemblies.



Act on code	(1) SMR CODE			(2) Federal stock No.	(3) Description Reference Number & Mfr Code      Usable on Code	(4) Unit of meas	(5) Qty inc in unit	(6) 30-day DS maint allowance			(7) 30-day GS maint allowance			(8) 1-Yr slw per 100 equip enrgy	(9) Depot maint slw per 100 equip	(10) Illustration	
	(a) Source	(b) Maint	(c) Recov					(a) 1-20	(b) 21-50	(c) 51-100	(a) 1-20	(b) 21-50	(c) 51-100			(a) Fig No.	(b) Item No.
N	PA-OZ-Z			1240-764-0802	BINOCULARS M15A1 (6705512) AND M17A1 (6702518) GUARD EYE 7640802 (19200)	EA	2	*	*	*	*	*	*	*	19	1	
N	PA-HZ-Z			5305-803-8218	SCREW, MACHINE NO 4-40NC-2A, 3/8 L NO 4-40NC-2A, 3/8 L MS35267-15 (96906)	EA	10	*	*	*	*	*	*	*	19	2	
N	XB-HZ-Z				COVER AND EYEPIECE ASSEMBLY 7672854 (19200)	EA	1								19	3	
N	XB-HZ-Z				COVER AND EYEPIECE ASSEMBLY 7676155 (19200)	EA	1								19	4	
N	PA-HZ-Z			5330-618-1555	GASKET RUBBER, 5 MTG HOLES, 0.037 THK. 6181555 (19200)	EA	2				*	*	*	*	19	5	
N	XB-HZ-Z				COVER AND EYEPIECE ASSEMBLY 7673633 (19200)	EA	1								19	6	
N	XB-HZ-Z				COVER AND EYEPIECE ASSEMBLY 7673635 (19200)	EA	1								19	7	
N	AH--				RETICLE ASSEMBLY 7636815 (19200)	EA	1								19	9	



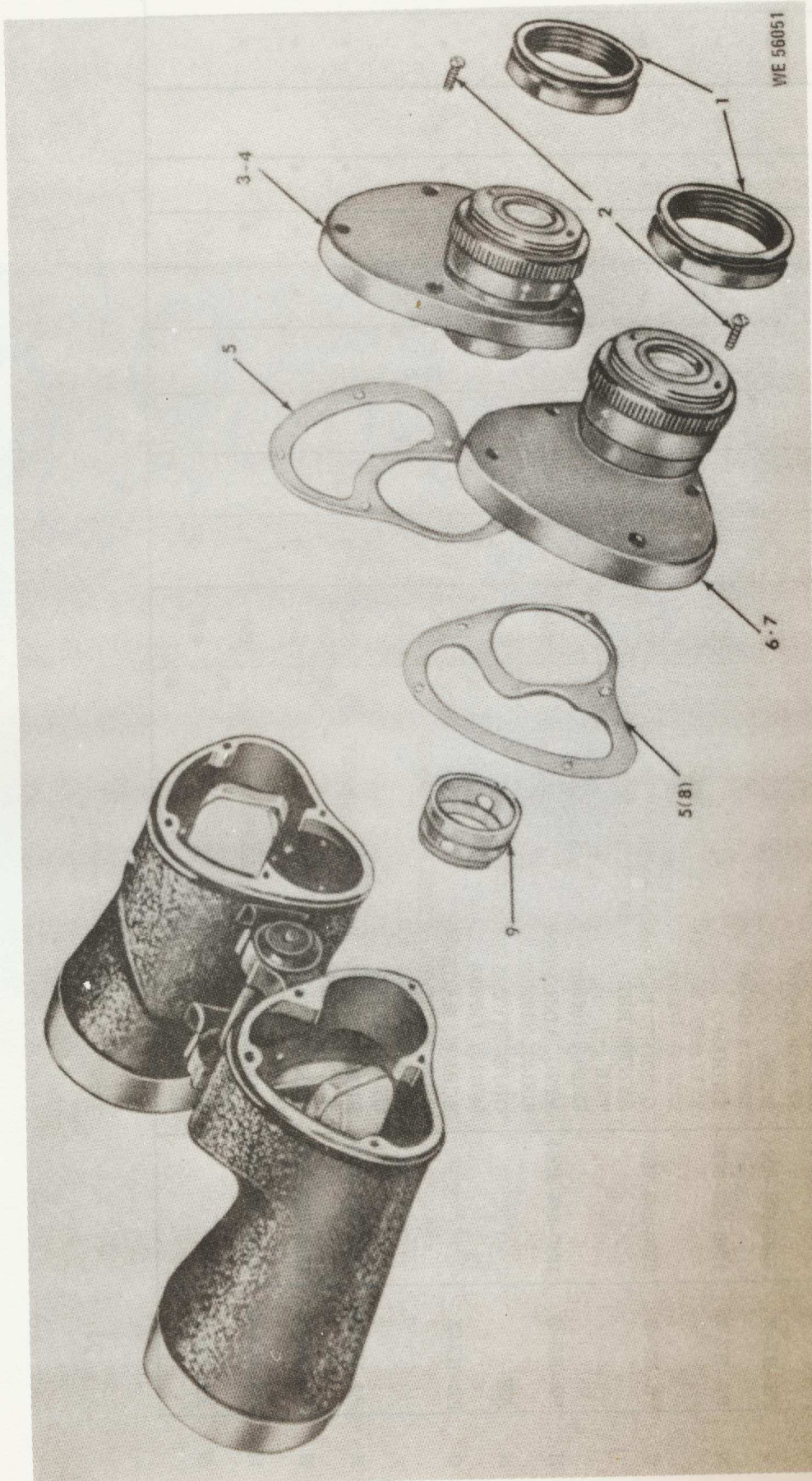
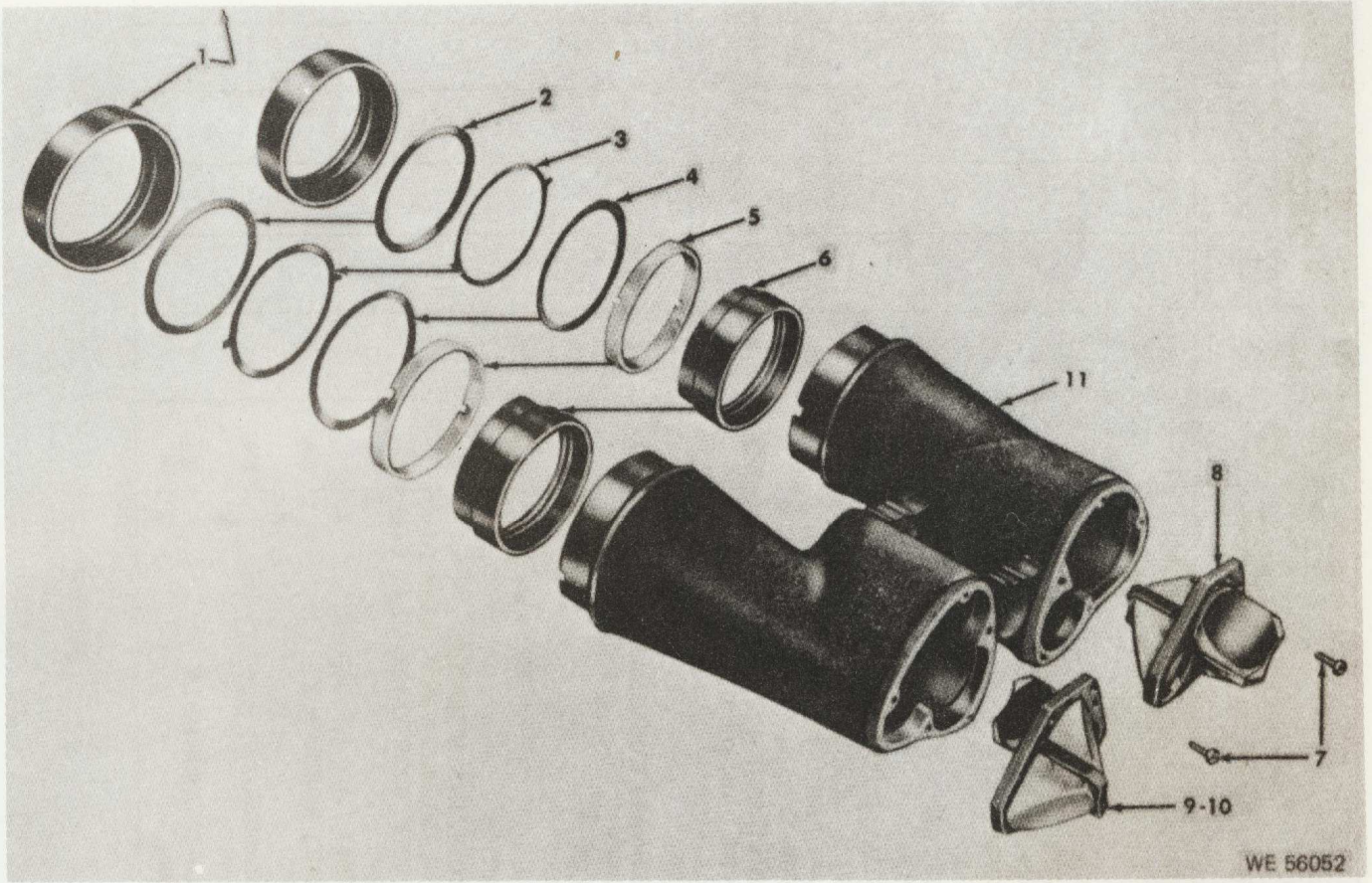

Figure 19. Binoculars M15A1 and M17A1









WE 56052

Figure 20. Body assembly w/related parts







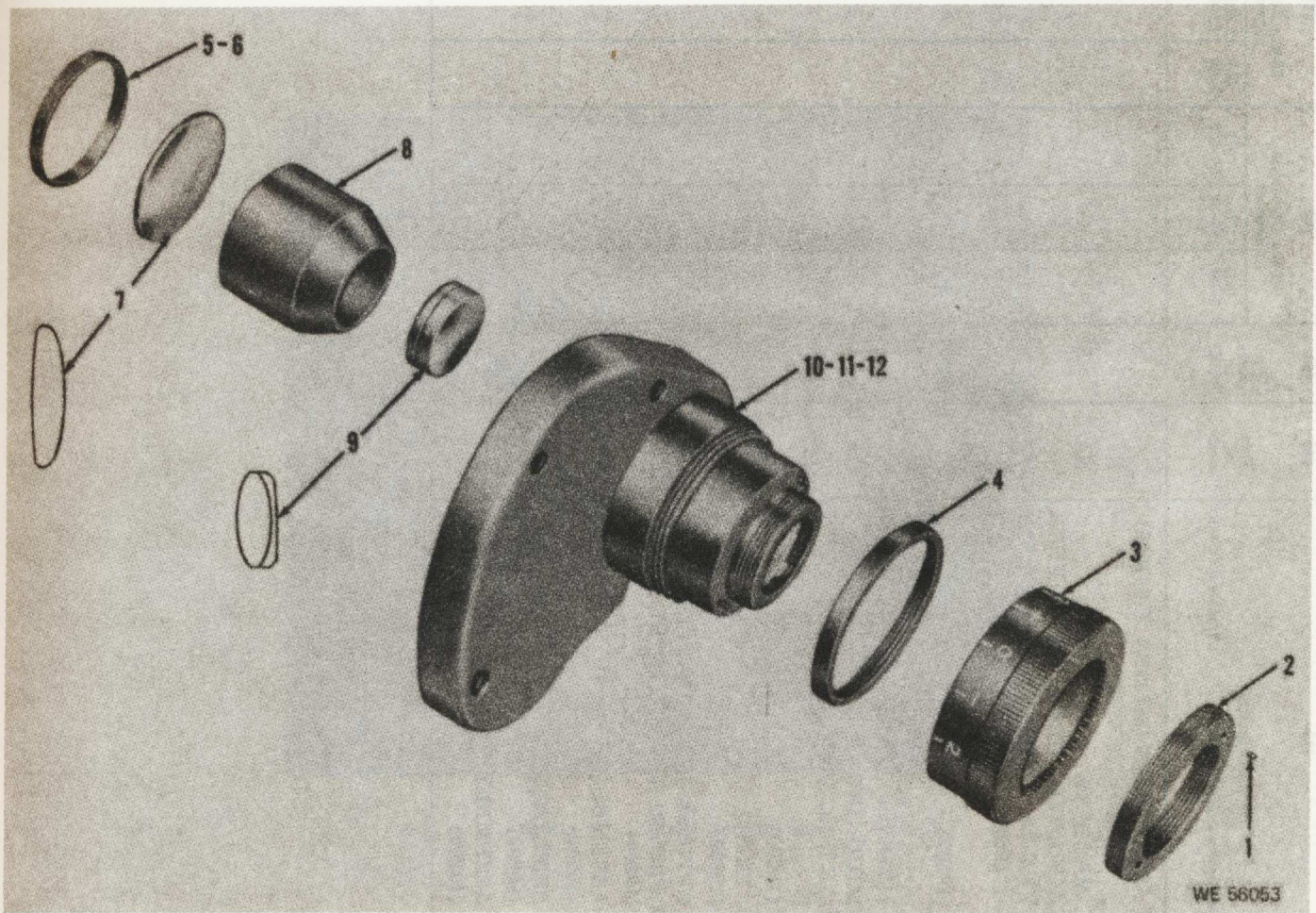

Figure 21. Cover and eyepiece assemblies.



Act on code	(1) SMR CODE			(2) Federal stock No.	(3) Description Reference Number & Mfr Code      Useful on Code		(4) Unit of meas	(5) Qty inc in unit	(6) 30-day DS maint allowance			(7) 30-day GS maint allowance			(8) 1-Yr slw per 100 equip entgcy	(9) Depot maint slw per 100 equip	(10) Illustration	
	(a) Source	(b) Maint	(c) Recov		(a) 1-20	(b) 21-50			(c) 51-100	(a) 1-20	(b) 21-50	(c) 51-100	(a) Fig No.	(b) Item No.				
N	PA-DZ-Z			5305-057-0497	SHELF ASSEMBLIES (5631930), (7631928) AND (7670776)		EA	8							*	22	1	
N	PA-DZ-Z			5340-627-0801	SCREW, MACHINE		EA	2							*	22	2	
N	PA-DZ-Z			1240-763-6865	PNH, CROSS-REC, CRES, PSVT FNSH, NO 2-64UNF-2A, 1/8 L		EA	2							*	22	3	
C	PA-DZ-Z			1240-518-3736	MS51958-1 (96906)		EA	4							*	22	4	
N	PA-DZ-Z			1240-617-7055	CLIP 6270801 (19200)		EA	4							*	22	5	
N	PA-DZ-Z			1240-520-4256	CLIP 7636865 (19200)		EA	4							*	22	6	
N	XB-DZ-Z				PAD, CUSHIONING		EA	1							*	22	7	
N	XB-DZ-Z				CELLULAR RBR, 3/32 OA W, 1/32 OA THK, 1/2 OA L		EA	1							*	22	8	
N	XB-DZ-Z				SHIELD, PRISM 6177055 (19200)		EA	1							*	22	9	
N	XB-DZ-Z				PRISM, OPTICAL INSTRUMENT GL, POR PSM, 90 DEGREE LT DEVN 5204256 (19200)		EA	1							*	22		
N	XB-DZ-Z				SHELF ASSEMBLY 6270803 (19200)		EA	1							*	22		
N	XB-DZ-Z				SHELF ASSEMBLY 6270804 (19200)		EA	1							*	22		
N	XB-DZ-Z				SHELF ASSEMBLY 7636813 (19200)		EA	1							*	22		



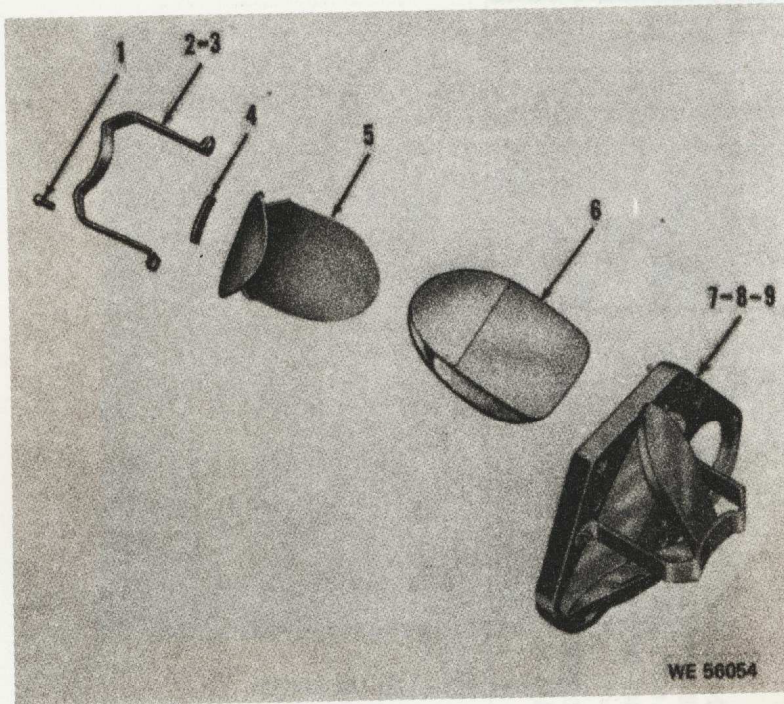
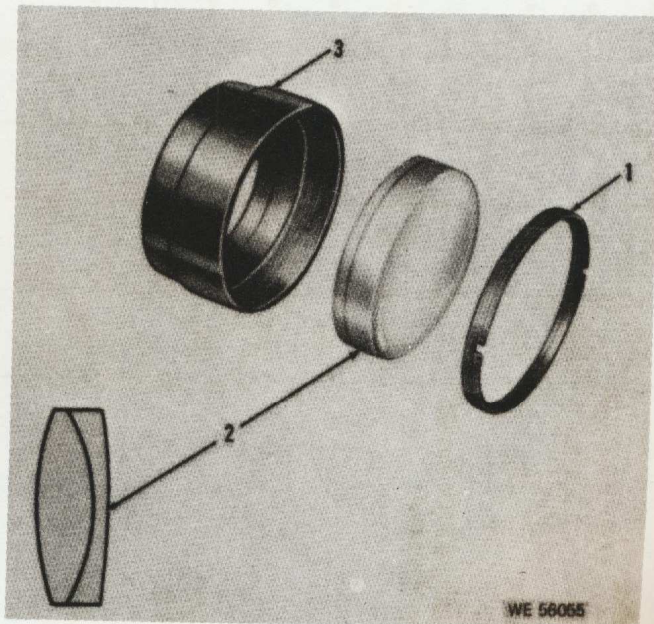

Figure 22. Shelf assemblies



Act on code	(1) SMR CODE			(2) Federal stock No.	(3) Description Reference Number & Mfr Code      Unable on Code	(4) Unit of meas	(5) Qty inc in unit	(6) 30-day DS maint allowance			(7) 30-day GS maint allowance			(8) 1-Yr alw per 100 equip entgy	(9) Depot maint alw per 100 equip	(10) Illustration	
	(a) Source	(b) Maint	(c) Recov					(a) 1-20	(b) 21-50	(c) 51-100	(a) 1-20	(b) 21-50	(c) 51-100			(a) Fig No.	(b) Item No.
C	PA-HZ-Z			5365-291-3554	OBJECTIVE ASSEMBLY (5631137) RING, EXTERNALLY THREADED AL, SLTD FACE DR, BLK DYE, FNSH 2-145-36UNS-3, 1.967 ID, 0.171 OA L, 0.062 SLOTS WD 5204263 (19200)      K	EA	1				*	*	*	*	*	23	1
N	PA-HZ-Z			1240-520-4255	LENS OPTICAL INSTRUMENT GL, DBL CONV MENISCUS DIVERGING 0.406 EDGE THK 0.571 AXIAL THK 2.048 DIA 7.958 EFL, 7.348 BFL 6.777 FFL 5204255 (19200)      K	EA	1				*	*	*	*	*	23	2
N	PA-HZ-Z			1240-617-7053	CELL, OPTICAL ELEMENT AL, INTL THD, 2.145-36 NS-3, 0.419 L 6177053 (19200)      K	EA	1				*	*	*	*	*	23	3





WE 56065

Figure 23. Objective assembly.

Part No.	Part Name	QTY	Notes
1	...	1	...
2	...	1	...
3	...	1	...
4	...	1	...
5	...	1	...
6	...	1	...
7	...	1	...
8	...	1	...
9	...	1	...
10	...	1	...
11	...	1	...
12	...	1	...
13	...	1	...
14	...	1	...
15	...	1	...
16	...	1	...
17	...	1	...
18	...	1	...
19	...	1	...
20	...	1	...
21	...	1	...
22	...	1	...
23	...	1	...
24	...	1	...
25	...	1	...
26	...	1	...
27	...	1	...
28	...	1	...
29	...	1	...
30	...	1	...
31	...	1	...
32	...	1	...
33	...	1	...
34	...	1	...
35	...	1	...
36	...	1	...
37	...	1	...
38	...	1	...
39	...	1	...
40	...	1	...
41	...	1	...
42	...	1	...
43	...	1	...
44	...	1	...
45	...	1	...
46	...	1	...
47	...	1	...
48	...	1	...
49	...	1	...
50	...	1	...
51	...	1	...
52	...	1	...
53	...	1	...
54	...	1	...
55	...	1	...
56	...	1	...
57	...	1	...
58	...	1	...
59	...	1	...
60	...	1	...
61	...	1	...
62	...	1	...
63	...	1	...
64	...	1	...
65	...	1	...
66	...	1	...
67	...	1	...
68	...	1	...
69	...	1	...
70	...	1	...
71	...	1	...
72	...	1	...
73	...	1	...
74	...	1	...
75	...	1	...
76	...	1	...
77	...	1	...
78	...	1	...
79	...	1	...
80	...	1	...
81	...	1	...
82	...	1	...
83	...	1	...
84	...	1	...
85	...	1	...
86	...	1	...
87	...	1	...
88	...	1	...
89	...	1	...
90	...	1	...
91	...	1	...
92	...	1	...
93	...	1	...
94	...	1	...
95	...	1	...
96	...	1	...
97	...	1	...
98	...	1	...
99	...	1	...
100	...	1	...



Section III. SPECIAL TOOLS LIST

Act on code	(1) SMR CODE		(2) Federal stock No.	(3) Description Reference Number & Mfr Code      Useable on Code		(4) Unit of meas	(5) Qty inc in unit	(6) 30-day DS maint allowance			(7) 30-day GS maint allowance			(8) 1-Yr slw per 100 equip enegy	(9) Depot maint slw per 100 equip	(10) Illustration	
	(a) Source	(b) Maint		(c) Recov	(a) 1-20			(b) 21-50	(c) 51-100	(a) 1-20	(b) 21-50	(c) 51-100	(a) Fig No.			(b) Item No.	
N	PA-CZ-Z		1240-769-4280	TOOLS AND EQUIPMENT EQUIPMENT CASE CARRYING M62A1 7694280 (19200)		EA	1	*	*	*	*	*	*	*	*	10	6
N	PA-CZ-Z		1240-769-4281	CASE, CARRYING, M63A1 7694281 (19200)		EA	1	*	*	*	*	*	*	*	*	24	7
N	PA-CZ-Z		1240-769-1956	FILTER, M1 7691956 (19200)		EA	1	*	*	*	*	*	*	*	*	11	6
C	PA-OZ-Z		1240-764-6236	STRAP, ASSEMBLY, NECK 7646236 (19200)		EA	1	*	*	*	*	*	*	*	*	24	6
				REPAIR PARTS FOR EQUIPMENT CASE, CARRYING M62A1 (7694280)													
C	PA-FZ-Z		5340-764-6842	CAP LARGE MS27986-4B (96906)		EA	20	*	*	*	*	*	*	*	*	10	2
	PA-FZ-Z			CATCH 7646842 (19200)		EA	1	*	*	*	*	*	*	*	*	10	5
	PA-FZ-Z			POST LARGE MS27986-3B (96906)		EA	20	*	*	*	*	*	*	*	*	10	1
N	PA-FZ-Z		1240-764-6234	STRAP WEBBING NYLON OLIVE DRAB, 3/4 W, 44 L BUCKEL TNG HOLES 7646234 (19200)		EA	1	*	*	*	*	*	*	*	*	10	3
N	PA-FZ-Z		1240-764-6235	STRAP WEBBING NYLON 1/16 THK, 3/4 W, 20 L 8 HOLES, 9/16 DIA. 7646235 (19200)		EA	1	*	*	*	*	*	*	*	*	10	4
				CASE, CARRYING M63A1 (7694281)													
	PA-FZ-Z			CAP, LARGE MS27986-4B (96906)		EA	20	*	*	*	*	*	*	*	*	24	2
N	PA-FZ-Z		5340-764-6842	CATCH 7646842 (19200)		EA	1	*	*	*	*	*	*	*	*	24	5
	PA-FZ-Z			POST, LARGE MS27986-3B (96906)		EA	20	*	*	*	*	*	*	*	*	24	1
N	PA-FZ-Z		1240-764-6234	STRAP 7646234 (19200)		EA	1	*	*	*	*	*	*	*	*	24	3
N	PA-FZ-Z		1240-764-6235	STRAP 7646235 (19200)		EA	1	*	*	*	*	*	*	*	*	24	4



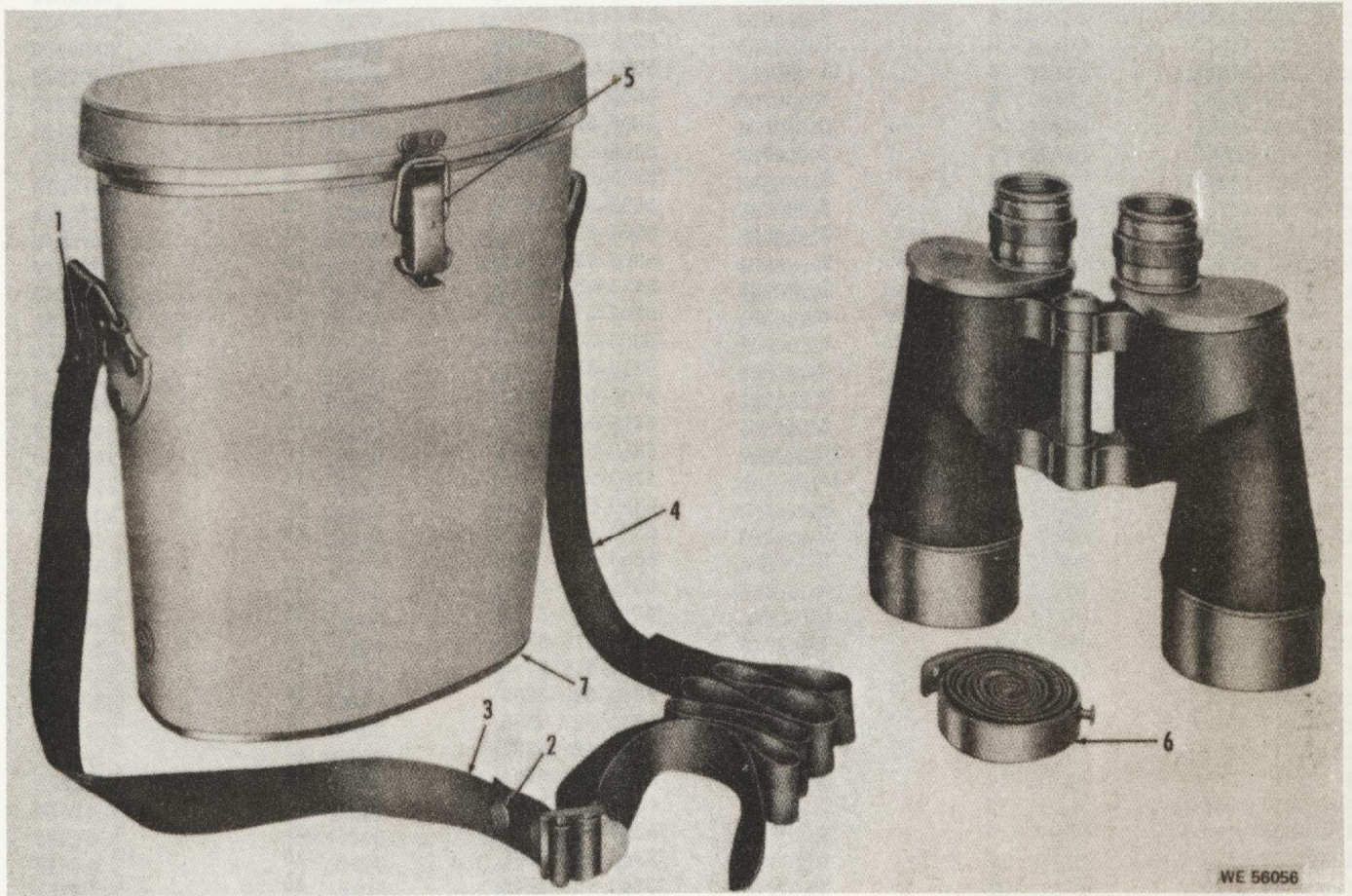

WE 56056

Figure 24. Case carrying M63A1



## Section IV. FEDERAL STOCK NUMBER AND REFERENCE NUMBER INDEX

STOCK NUMBER	FIGURE NO.	ITEM NO.	STOCK NUMBER	FIGURE NO.	ITEM NO.	
1240-318-4399	13	1	1240-764-6236	24	6	
1240-507-8280	21	5	1240-767-0776	20	10	
1240-518-2044	15	13	1240-767-0787	12	15	
1240-518-3736	6	4	1240-767-4879	7	13	
1240-518-3736	16	4	1240-769-1956	11	—	
1240-518-3736	22	4	1240-769-4280	10	6	
1240-518-5191	5	10	1240-769-4281	24	—	
1240-518-5191	8	8	5305-057-0497	22	1	
1240-518-5192	5	9	5305-081-2651	3	4	
1240-518-5192	8	6	5305-081-2651	15	4	
1240-518-5193	4	7	5305-207-8845	3	1	
1240-518-5194	6	6	5305-207-8848	2	7	
1240-518-5454	3	11	5305-207-8848	7	10	
1240-518-5466	4	4	5305-282-7659	17	1	
1240-520-4255	14	6	5305-527-5546	16	1	
1240-520-4255	23	2	5305-637-8220	12	7	
1240-520-4256	16	8	5305-638-1786	5	2	
1240-520-4256	22	6	5305-638-1786	8	1	
1240-520-4750	9	3	5305-638-1786	21	1	
1240-531-8120	12	1	5305-734-1581	15	1	
1240-531-8120	20	1	5305-757-8741	7	2	
1240-531-9082	9	4	5307-520-4268	16	15	
1240-531-9083	4	9	5305-805-8218	19	2	
1240-532-0684	21	4	5310-530-9441	4	2	
1240-532-0685	14	2	5315-518-3732	3	10	
1240-532-0685	20	3	5315-518-3732	15	12	
1240-557-9390	7	12	5315-520-4269	16	7	
1240-558-0619	12	14	5330-290-7836	14	3	
1240-558-0620	12	8	5330-290-7836	20	4	
1240-563-1928	20	9	5330-618-1555	19	5	
1240-563-1930	20	8	5330-626-9516	7	7	
1240-565-1003	14	4	5365-291-3554	23	1	
1240-565-1003	20	5	5340-518-3733	15	11	
1240-574-6417	9	1	5340-518-3734	3	6	
1240-617-3980	9	2	5340-518-3734	15	6	
1240-617-4608	6	5	5340-520-4266	16	3	
1240-617-7053	14	7	5340-527-4503	3	9	
1240-617-7053	23	3	5340-627-0801	22	2	
1240-617-7055	16	5	5340-664-0094	14	1	
1240-617-7055	22	5	5365-664-0094	14	1	
1240-695-0154	15	9	5340-757-8186	13	3	
1240-757-5229	17	6	5340-757-9001	15	10	
1240-757-5229	21	7	5340-764-6842	10	5	
1240-757-5230	17	8	5340-764-6842	24	5	
1240-757-5230	21	9	5355-531-8012	15	3	
1240-507-8280	17	4	5365-200-5399	17	5	
1240-757-8184	13	5	5365-200-5399	21	6	
1240-758-6838	2	1	5365-291-3554	14	5	
1240-758-6838	7	14	5365-291-3578	5	3	
1240-763-3945	16	6	5365-291-3578	8	2	
1240-763-4626	17	10	5365-291-3579	17	2	
1240-763-4627	17	9	5365-520-4262	18	1	
1240-763-6816	13	2	5365-758-4929	21	2	
1240-763-6865	22	3	5365-758-6840	4	1	
1240-764-0802	12	3	6650-557-9390	2	8	
1240-764-0802	19	1	1240-695-0154	3	8	
1240-764-0806	2	3	1240-767-4879	2	14	
1240-764-0806	7	1				
1240-764-1795	4	5				
1240-764-6234	10	3				
1240-764-6234	24	3	REFERENCE	MFR.	FIGURE	ITEM
1240-764-6235	10	4	NO.	CODE	NO.	NO.
1240-764-6235	24	4	MS27986-3B	96906	10	1
1240-764-6235	24	4	MS27986-3B	96906	24	1
1240-764-6235	24	4	MS27986-4B	96906	10	2



REFERENCE NO.	MFR. CODE	FIGURE NO.	ITEM NO.	REFERENCE NO.	MFR. CODE	FIGURE NO.	ITEM NO.
MS27986-4B	96906	24	2	5204267	19200	16	2
MS35267-15	96906	19	2	5204268	00000	16	15
MS51038-15	96906	3	4	5204269	19200	16	7
MS51038-15	96906	15	4	5204750	19200	9	3
MS51038-15	96906	15	8	5318012	00000	15	3
MS51031-1	96906	3	2	5318014	19200	14	1
MS51958-1	96906	22	1	5318014	00000	20	2
MS51960-17	96906	15	1	5318015	19200	14	3
225417	81348	20	7	5318015	21450	20	4
5044192	00000	2	5	5318120	19200	20	1
5044192	00000	12	5	5319082	19200	9	4
5044193	19200	3	1	5319083	19200	4	9
5044194	00000	16	1	5320684	19200	21	4
5182042	19200	3	8	5320685	19200	14	2
5182042	19200	15	9	5320685	19200	20	3
5182043	19200	3	5	540963	21450	17	1
5182043	19200	15	5	541053	21450	15	2
5182044	19200	15	13	5579385	00000	2	15
5183732	19200	3	10	5579390	19200	2	8
5183732	19200	15	12	5579390	19200	7	12
5183733	19200	15	11	5318120	19200	12	1
5183734	19200	3	6	5579391	19200	3	12
5183734	19200	15	6	5579392	19200	3	14
5183735	19200	12	7	5580616	19200	12	16
5183736	19200	6	4	5580619	19200	12	14
5183736	19200	16	4	5580620	19200	12	8
5183736	19200	22	4	5580621	19200	15	16
5185191	19200	5	10	5580622	19200	15	14
5185191	19200	8	8	5631137	19200	20	6
5185192	19200	5	9	5631255	19200	7	16
5185192	19200	8	6	5631256	19200	3	15
5185193	19200	4	7	5631257	19200	3	13
5185194	19200	6	6	5631928	19200	20	9
5185454	19200	3	11	5631930	19200	20	8
5185455	19200	3	3	5632009	19200	20	11
5185456	19200	3	9	5632010	19200	15	17
5185458	19200	5	7	5632011	19200	15	15
5185458	19200	8	5	6173980	19200	9	2
5185459	19200	5	11	6174600	19200	2	11
5185459	19200	8	7	6174603	19200	5	1
5185460	19200	5	3	6174608	19200	6	5
5185460	00000	8	2	6177047	19200	16	18
5185461	19200	5	2	6177048	19200	16	17
5185461	19200	8	1	6177049	19200	18	2
5185461	19200	21	1	6177050	19200	18	4
5185462	19200	5	5	6177051	19200	17	3
5185462	19200	8	9	6177053	19200	14	7
5185463	19200	5	8	6177053	19200	23	3
5185463	19200	8	4	6177055	19200	16	5
5185465	19200	4	8	6177055	19200	22	5
5185466	19200	4	4	6177065	19200	12	11
5185468	19200	6	2	6177066	19200	12	6
5185469	19200	6	1	6181431	19200	14	4
5185474	19200	6	3	6181431	19200	20	5
5185475	19200	9	1	6181555	19200	19	5
5185480	00000	2	7	6269516	19200	7	7
5185480	00000	7	10	6269643	19200	5	4
5204255	19200	14	6	6269643	19200	8	3
5204255	19200	23	2	6270801	19200	22	2
5204256	19200	16	8	6270803	19200	22	7
5204256	19200	22	6	6270804	19200	22	8
5204261	00000	17	2	7199590	19200	2	12
5204262	19200	18	1	7199590	19200	7	9
5204263	19200	14	5	7278201	19200	13	4
5204263	19200	23	1	7575229	19200	17	6
5204266	19200	16	3	7575229	19200	21	7



By Order of the Secretary of the Army:

Official:

VERNE L. BOWERS  
*Major General, United States Army*  
*The Adjutant General.*

W. C. WESTMORELAND  
*General, United States Army*  
*Chief of Staff*

**DISTRIBUTION:**

To be distributed in accordance with DA Form 12-41 (qty rqr block no. 8), Direct/General Support requirements for Binoculars.

★ U.S. GOVERNMENT PRINTING OFFICE: 1982-375-474/4097



DEPARTMENT OF THE ARMY  
US ARMY AG PUBLICATIONS CENTER  
1655 WOODSON ROAD  
ST. LOUIS, MISSOURI 63114

OFFICIAL BUSINESS  
PENALTY FOR PRIVATE USE, \$300

POSTAGE AND FEES PAID  
DEPARTMENT OF THE ARMY  
DOD 314

